



Get your kicks.

ULTRASPORT 2004

4075 FLOOR PLAN

ILLINOIS MISSOURI KANSAS OKLAHOMA TEXAS NEW MEXICO ARIZONA CALIFORNIA



Hackberry General Store, Hackberry, Arizona

AN ALL DIESEL PUSHER AT A GAS PRICE.

Ultrasport™ is made for veteran motorhomers, the ones who are ready for the ultimate RV experience. It's a stylish, powerful diesel pusher priced no more than some gas powered coaches. Plus, it's designed as a diesel from the ground up.



DAMON
MOTOR COACH

300 MILES
DESERT AHEAD

THE NEW ULTRASPORT™ 4075 FLOOR PLAN

Bathroom

Full-height fiberglass tub or shower with door	S
Skylight in shower and power vent	S
Foot-flush porcelain toilet with sprayer	S
Medicine cabinet with solid-wood door and mirror	S
Wallpaper border	S

Bedroom

Pillowtop mattress with bedspread and throw pillows	S
Lined wardrobe with mirrored doors	S
TV area and jack	S
20" color TV	O
Lambrequin window treatments	S
Day/night shades	S
Pin-up lights	S
AM/FM/CD player	O

Chassis

Raised-rail chassis	S
330-hp Caterpillar® engine	O
In-block engine heater	S
Leece Neville® 160-amp, 12-volt alternator	S
Allison® MH-3000 automatic transmission — 6-speed	S
Exhaust brake	S
Full anti-lock air brakes with automatic slack adjusters (front and rear)	S
Midland® Pure-Air Plus™ heated air dryer	S
Air-ride suspension	S
22.5" radial tires	S
Fully automatic leveling jacks with touchpad controls	S
Stainless-steel wheel liners	S
Full-width stainless-steel stone guard with Damon stencil	O
Trailer hitch (5,000 lbs.)	S
Emergency start circuit	S
Under-hood light	S
Layer of neoprene vibration dampener	S
Dual fuel fills	S

S=Standard O=Optional

Cockpit

Molded ABS dash	S
Electronically controlled dash air conditioning	S
Premium AM/FM radio with in-dash CD player	S
Premium AM/FM/cassette radio with multi-disc CD changer	O
XM-satellite radio tuner	O
Premium 4-speaker system with powered subwoofer	S
Electronic cruise control	S
18" padded steering wheel	S
Douglas® tilt/telescoping steering column	S
Map lights and dash fans	S
Air horns	S
Tinted wraparound windshield with privacy drape	S
Front-mounted power mirrors with heat	S
Floor mats	S
Deluxe entry mats	O
Ultra-leather reclining driver's seat with 6-way power and passenger seat	S
Ultra-leather reclining passenger seat with 6-way power and power footrest	O
3-point, wall-mounted seat belts	S
Storage cabinets above driver and passenger	S
Sun visors	S
Electric sun visors with manual side shade	O
Backup monitor system with audio	S
Drink holders	S

Exterior

Deluxe graphics package with paint	S
Full-body paint package including color-coordinated Carefree® slideroom awnings	O
Color-coordinated Carefree® entry door awning and patio awning with remote control (required with full-body paint)	O
Color-coordinated Carefree® window awnings (only available with full-body paint)	O
Fog lights and driving lights	S
BriteTEK TPO roof (n/a with full-body paint)	S
Seamless fiberglass roof (required with full-body paint)	O
Roof vents and rear ladder	S
Aerodynamic front and rear fiberglass caps with integrated, contoured bumpers	S

Exterior (cont.)

Awning rail	S
Side-mounted manual patio and front door awnings	O
Side-mounted awning over slideout	S
Carefree® electric patio awning with remote control	O
Carefree® manual front door awning	O
Entry-assist lighted grab handle	S
High-gloss, gelcoated fiberglass sidewall	S
Black-framed radius-cornered windows	S
Black-framed, dual-pane windows	O
Two porch lights (one on each side)	S
Full basement, lighted pass-through storage	S
Easy-slide storage tray	O
Exterior entertainment center with 20" TV	O
Gas pistons on exterior storage doors	S
RVQ grill	O
Diamond Shield® front paint film	O

Kitchen

Refrigerator: large flush-mounted, double-door with solid-wood front (oak or maple)	S
Refrigerator: large flush-mounted, double-door with icemaker	O
Refrigerator: side-by-side with icemaker IPO standard refrigerator and pantry	O
3-burner range and oven	S
Cooktop IPO range and oven	O
Microwave oven	S
Microwave/convection oven	O
Dishwasher IPO range and oven	O
Lighted power range hood and monitor panel with LPG readout	S
Double-bowl sink with oversized dish bowl and single-lever faucet with sprayer	S
Pantry	S
Corian® countertops with two sink covers and range cover	S
Solid-wood cabinet doors (oak or maple) with platinum style hardware	S
12" x 12" vinyl tile flooring	S
Plank flooring in kitchen and bath (oak or maple)	O
Ceramic tile flooring in kitchen and bath	O
Booth dinette with padded top, deep storage drawers and Corian®-edged table	O

Kitchen (cont.)

Freestanding dinette with 2 chairs	S
2 folding chairs (available with freestanding dinette or buffet)	O
Buffet with additional storage	O
Mini blinds	S
Fantastic® power vent	S
Fantastic® power vent with rain sensor	O
Fire extinguisher	S

Living Area

Sofa bed (décor fabric)	S
Sofa bed (ultra-leather)	O
Hide-a-bed (décor fabric) (N/A with magic bed)	S
Hide-a-bed (ultra-leather) (N/A with magic bed)	O
Magic bed (ultra-leather) (replaces sofa bed)	O
Magic bed (ultra-leather) (replaces hide-a-bed)	O
Day/night shades	S
100% nylon carpeting with stain treatment and padding	S
27" color TV in cockpit overhead with full-function remote, antenna booster and jack	S
Video package (VCR/DVD and control center)	S
Theater sound (TV/VCR/DVD/CD with home theater)	S
Home theater package (VCR, DVD/CD player and 5-channel Dolby® Pro-Logic receiver amplifier)	O
Decorator clock and mirror	S
Fabric ceiling	S
Living room pin-up lights and aisle lights	S
Lined overhead cabinets throughout	S

Utilities

Air conditioner: 13,500-BTU ducted center (front and rear)	S
Dual heat pumps with 15,000-BTU A/C and 12,700-BTU heat (n/a with optional A/C)	O
5-watt chassis solar battery charger (N/A with low-profile A/C or heat pump)	O
Furnace: 35,000-BTU electronic ignition, floor-ducted	S
Motoraid® auxiliary rear heater	O
Water heater: 10-gallon gas/electric with electronic ignition	S
Water heater: Motoraid® 10-gallon gas/electric with electronic ignition	O

Utilities (cont.)

Water heater bypass kit	S
Generator: 7.5 kW Generac® Quietpac™	S
Generator: 7.5 kW Onan® Quiet Diesel™	O
Generator: 8.0 kW Power-Tech® "CAT"	O
600-watt entertainment inverter or 2500-watt inverter	O
Converter: solid-state 75-amp, 12-volt	S
12-volt demand water pump	S
6-volt Thermoll® auxiliary batteries (two standard, four with 2500-watt inverter)	S
Electronic battery distribution center	S
Battery disconnect	S
50-amp, 120-volt service with marine-type detachable power cord	S
Energy management system	O
Enclosed heated potable and holding tanks	S
Black-water tank flush	S
Three-way valve for tank/city water fill	S
Water filtration system	S
Washer/dryer prep	S
Washer/dryer combo	O
Telephone and cable hookups, prewired for roof-mounted satellite dish	S
DSS manual satellite dish	O
DSS automatic-tracking satellite dish	O
DSS "in-motion" satellite dish	O
Exterior shower	S
Carbon monoxide, LP gas and smoke detectors	S

Weights and Measures

Chassis	Freightliner®
Wheelbase	266"
GVWR (lbs.)	31,000
Overall length	41'1"
Overall width	101"
Overall height with A/C	12'3"
Fresh water system (appx. gal.)	100
Gray and black water (appx. gal. each)	50
LP (lbs.)	126
Sleeping capacity	5
Fuel capacity (appx. gal.)	100

KEY BENEFITS

The Ultrasport 4075's "dual-zone living" (seating in the living area and bedroom) offers a more residential experience.

The rear seats provide a beautiful, panoramic view of your surroundings from the privacy of your bedroom.

Our 40-inch-deep slideout is the deepest flush-floor slideout in the industry.

The shower stall with door and skylight is extremely large and spacious.

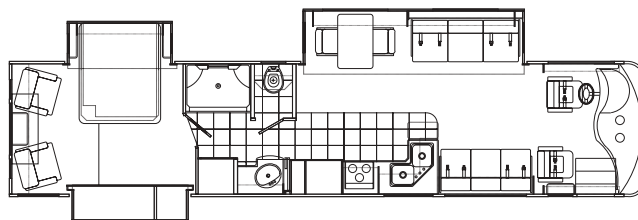

DAMON
MOTOR COACH

P.O. Box 2888 • Elkhart, IN 46515
Literature or Dealers: 574-389-0179 or 800-577-5692
Customer Service: 800-860-3812
Sales Department: 800-860-3812
www.DamonRV.com