



REVOLUTION and REVOLUTION LE Class A Diesel 2005



{Revolution}

Revolution Floor Plans

38B

Double Slide-Out
Sleeps 3

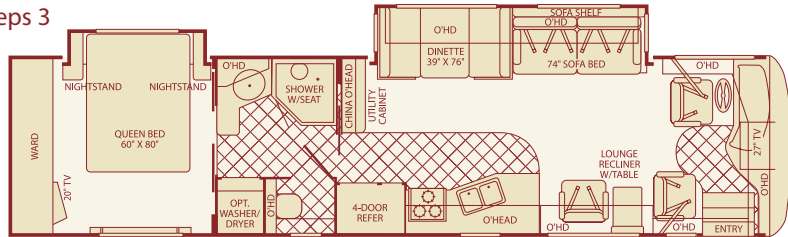

40C

Double Slide-Out
Sleeps 2

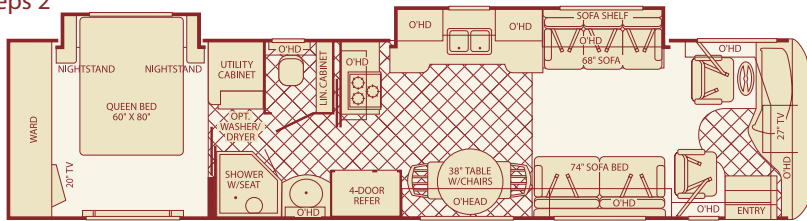

40D

Triple Slide-Out
Sleeps 2

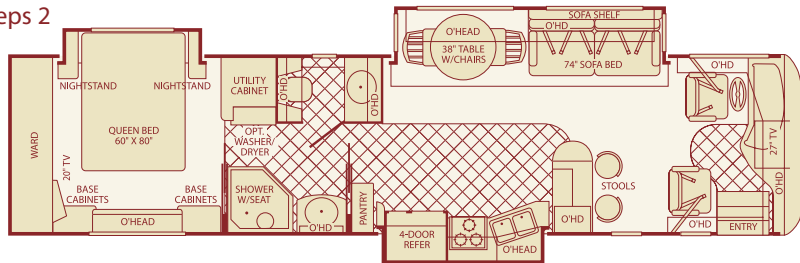

Available Options:

Revolution & Revolution LE



OPT. 115 THREE BURNER RANGE & 22" OVEN

Available in:
all floor plans.



OPT. 126 WASHER/DRYER

Available in:
all floor plans.



OPT. 149 NORCOLD 4 DOOR REFRIGERATOR W/ICE MAKER

Available in:
all LE floor plans.



OPT. 176 ULTRALEATHER W/INSERT J-STYLE SOFA

Available in:
38B, 38X, 40C,
40E, 40J, 40L



OPT. 830 FACING DINETTE

Available in:
38X, 40C, 40D,
40E, 40J, 40L



OPT. 869 BEDROOM O'HEAD AND BASE CABINET

Available in:
38B, 38X, 40C,
40E, 40J

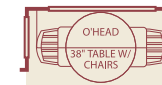

OPT. 876 FREE-STANDING DINETTE

Available in:
38B

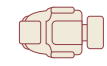

OPT. 496 ULTRALEATHER W/INSERT W/6-WAY POWER PASSENGER SEAT W/ELECTRIC FOOTREST

Available in:
all floor plans.

Revolution LE Floor Plans

38X

Triple Slide-Out
Sleeps 2

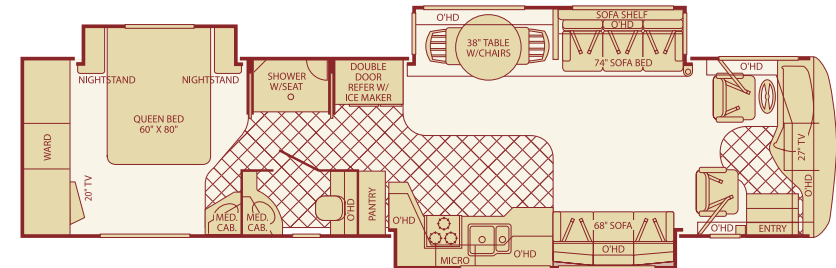

40C

Double Slide-Out
Sleeps 2

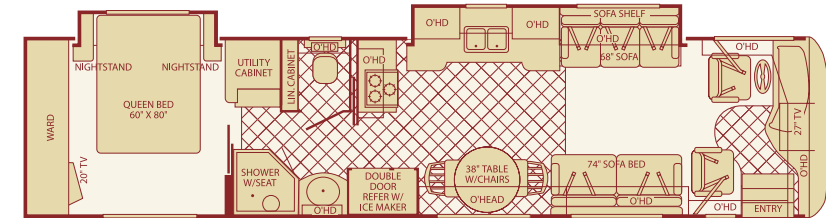

Revolution

Standard Features

Interior

THROUGHOUT

- **84" Interior Height w/Flat Ceiling***
- **Fabrica® Carpeting***
- Tile Floor at Front Entry (Laid Diagonally)
- Entry Step Switch at Entry Wall
- Centralized Control Panel Display Center
- Padded Vinyl Ceiling
- Day/Night Pleated Shades
- Solid Wood Drawers
- 12V Fluorescent Ceiling Lighting System
- Power Vent w/Rain Sensors (All Vents, Galley, Bath & Shower Area)
- Deluxe Ball Bearing Drawer Guides w/Full Extension Hardware on All Drawers
- Solid Core Raised Panel Upper Cabinet Doors
- Smoke Detector/Alarm
- Choice of Walnut, Regency Cherry or Clear White Maple Cabinetry
- Fire Extinguisher
- LPG Detector/Alarm
- Carbon Monoxide Detector/Alarm
- Back-Up Alarm
- Direct Spark Ignition 10 Gallon Water Heater 120V/LPG
- Tank Level Monitor (Interior Only)

DRIVER CONVENIENCE

- **Soft Touch Smart Wheel***
- **Visteon® AM/FM Radio w/Single CD Player***
- **Adjustable Brake & Throttle Pedals***
- **Tilt/Telescoping Steering Wheel w/Adjustable Dash Gauge Package***
- **Rear Vision System w/One-Way Audio (Camera & Monitor)***
- Cruise Control
- Passenger Drink Holder
- Flip Down Driver's Drink Holder
- Auxiliary Start Switch
- Auxiliary Fog Lights
- Driver's Window w/Slider
- (3) Power Driver/Passenger Sun Visors
- Driver Manual Side Pull Down Shade
- (2) Auxiliary 12V Dash Receptacles
- Manual Air Dump Switch
- I.C.C. Light Switch
- Driver/Passenger Map Lights
- Flexsteel® Ultraleather Driver/Passenger Seats w/Manual Lumbar/6-Way Power
- Battery Disconnect Switch
- Pneumatic Step Well Cover

LIVING ROOM

- **Flexsteel® Lounge Recliner w/Flip Up/Down Table (38B)***
- **Flexsteel® Ultraleather Sofa Bed***
- **Flexsteel® Ultraleather Love Seat***
- **TracVision® Domed Digital Satellite System***
- **27" Panasonic® TV***
- **Panasonic® Home Theater System w/DVD Player***
- 4-Head Hi-Fi Panasonic® VCR
- Park Telephone Ready
- TV Cable Ready

GALLEY

- **Norcold® 120V/LPG Electric 12 cu. ft. 4-Door Refrigerator w/Icemaker***
- **Satin Polished Solid Surface Range Covers***
- **GE® Convection Microwave Oven w/Built In Range Hood***
- **Satin Polished Solid Surface Sink Covers***
- **Satin Polished Solid Surface Galley Countertop***
- **High Rise Galley Faucet w/Extendable Sprayer***
- **Base Cabinet Storage for the Range & Galley Sink Covers***
- **Large 70/30 Split Solid Surface Galley Sink***
- Recessed 3 Sealed Burners Cook Top (Black Acrylic Finish)
- Bar Stools (40D)
- Satin Polished Solid Surface Backsplash w/Black Smoked Mirrors
- Ceramic Tile Flooring w/Accent (Laid Diagonally)
- Hardwood Dinette Table, 2 Flexsteel® Chairs & 2 Folding Chairs
- 120V Outlet & Telephone Jack at Dinette

BEDROOM

- **60" x 80" Full Queen Bed Mattress***
- **Cedar Lined Wardrobe***
- Black Smoked Beveled Mirrors
- Day/Night Pleated Shades
- Satin Polished Solid Surface Nightstand and Base
- Cedar Cabinet Countertops
- Secondary Phone Jack
- 20" Panasonic® TV
- DSS 2nd Receiver Ready – Bedroom Area (Coax Cable)

BATHROOM

- **Satin Polished Solid Surface Lavy Top w/Porcelain Bowl & Moen® Faucet***
- **Moen® Hand Held Shower Head***
- Deluxe Medicine Cabinet
- Ceramic Tile Flooring (Laid Diagonally)
- Skylight in Shower
- Flip Down Shower Seat (Select Models)
- Shower Door w/Obscure Glass
- Residential China Bowl Flush Toilet w/Hand Sprayer

Revolution & LE Exclusives

- **Energy Management System (EMS) w/ Soft Start***
- **Vacu-Bond® Upper/Lower Floors***
- **Complete TuffPEX® Plumbing System***
- **84" Interior Ceiling Height***

- **Liberty Chassis With Patent Pending* (LE Only)**

* Denotes Fleetwood's Key Features

40E

Triple Slide-Out
Sleeps 2

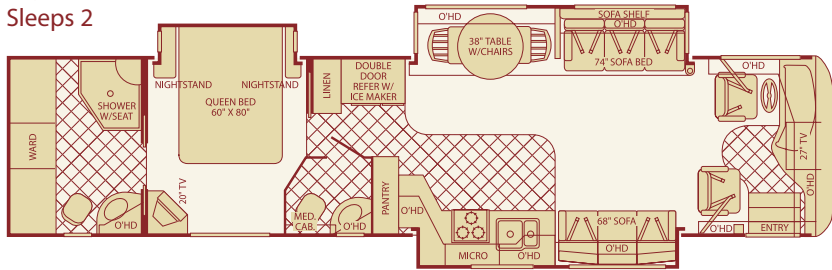

40J

Triple Slide-Out
Sleeps 2

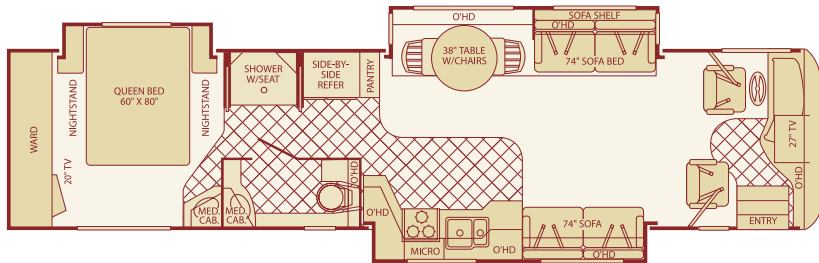

40L

Quad Slide-Out
Sleeps 2

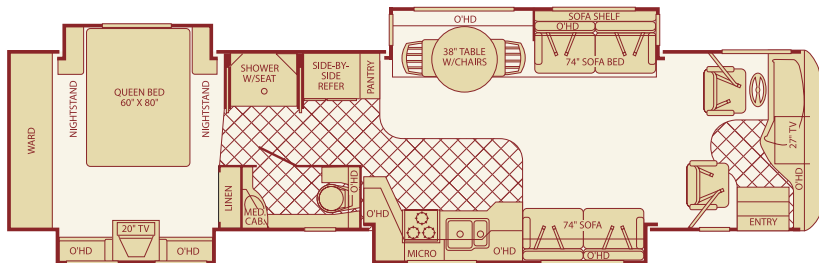

Seatbelt configuration may vary depending on options chosen. Sleeping capacity based on standard layout. Optional furniture may increase or decrease sleeping capacity.

Standard Features

Exterior

THROUGHOUT

- Dual 13,500 BTU Roof Air Conditioners*
- Energy Management System (50 Amp)*
- Denso Climate Control System*
- Onan® 7.5 kW Quiet Diesel Generator*
- Bus Style Large 50" Tall One-Piece Windshield*
- Domed One-Piece Fiberglass Roof w/Radius Corners*
- Dual Pane Windows w/Screens*
- Window Awnings (Bedroom & Front Roadside Window)*
- Trailer Hitch Receiver, 10,000 lbs.*
- Magnum® 2000 Watt Inverter
- Magnum® Battery Monitor
- Exterior Convenience Light at Dump Valves
- 50 Amp Power Cord
- Multi – Point Water Pump Switching
- Holding Tank w/Low Point Drain Valves
- Dual Holding Tank San-T-Flush™ System
- Exterior Rinse Hose
- Fresh Water Gravity Fill
- Variable Speed Aquatec Water Pump
- Park Telephone Ready
- Patio Receptacles
- Two Piece Rear Ladder
- (4) Aluminum Wheels
- Steel Surface on Front Bulkhead/Engine Frame
- Sound Insulation - Front & Rear
- Auxiliary Fog Lamps
- Electronic Battery Control Center

AUTOMOTIVE

- 3-Point Power Gear Leveling Jacks*
- Allison® 3000 MH, 6 – Speed Automatic Transmission*
- (4) 6-Volt House Batteries (440 Amp)*
- I-Beam Suspension w/Bilstein® Shocks
- Full Air Brakes w/Automatic Slack Adjusters
- Anti-Lock Brake System (ABS)

BODY STRUCTURE

- Heated Water & Holding Tank Compartments*
- Interlocking Ceiling to Sidewall Tubular Steel Construction*

SAFETY/CONVENIENCE

- Keyless Entry Includes Key Fob*
- Power Entry Step w/Last Out Feature*

STORAGE

- Exterior Flip-Up Compartment Doors

- Top Mounted Intermittent Wipers
- (4) Mud Flaps
- Utility Light Front & Rear
- Hadley® Air Horns (Bulkhead Mounted)
- Full Fiberglass Front & Rear Caps
- Large Windshield Washer Bottle w/Sprayer Nozzles
- European Style Automotive Headlights
- Fiberglass Front Fascia
- Protective Front Vinyl Cover without Logo
- Fiberglass Front & Rear Quarter Panels
- Fiberglass Wheel Trim
- Fiberglass Molded Front Bumper
- Front Entry Door Awning
- Eclipse Electric Patio Awning

- Tire Pressure Check Gauge
- 160 Amp Alternator
- (2) 12V Chassis Batteries (1000 Cold Cranking Amps Each Battery)
- Rear Radiator Configuration

- Bonded One-Piece Windshield w/Steel Frame Support*
- Vacu-bond® Sidewall, Roof & Floor Construction*

- Porch Lights (2)
- Front & Rear Docking Lights
- 30" Front Entry Door w/Dead Bolt
- Lighted Luggage Compartments

- Vacu-bond® Insulated Storage Area

- (4) Turn Signal Lamps on Each Side of Coach
- Illuminated Entry Assist Handle

Options

THROUGHOUT (INTERIOR)

- Central Vacuum System w/Accessory Kit
- SOC – Interior Request
- Vented Washer & Dryer
- Flexsteel® Ultraleather J-Style Sofa

AUTOMOTIVE

- Spartan® Stack Rail Chassis w/350 HP Cat® C7 Engine
- CSA Spartan® Package

DRIVER CONVENIENCE

- GPS Navigation System w/Sony® Color Back-up Monitor
- OnStar® Navigation System (First year subscription included)
- CB Radio Ready
- Visteon® In Dash CD-6 w/Sirius® Satellite Radio (First year subscription included)

- Flexsteel® Ultraleather Passenger Wider Seat/6-Way Power/Electric Footrest

BEDROOM

- Ceiling Fan
- Bedroom Base Cabinet & Overhead (38B & 40C models only)

GALLEY/LIVING ROOM

- Recessed 3 Sealed Burner Range w/Oven & Solid Surface Covers
- CSA Recessed 3 Sealed Burner Range w/Oven & Solid Surface Covers
- Facing Dinette (40C & 40D only)
- Dinette Table w/Free Standing Dinette & 2 Flexsteel® Chairs & 2 Folding Chairs (38B model only)

THROUGHOUT (EXTERIOR)

- Rear Rock Guard Mud Flap w/Logo
- Exterior Entertainment Center (20" Panasonic® TV w/Swivel Slide Out Tray)
- In-Motion TracVision® Domed Digital Satellite System
- Dual 13.5 M Roof Air Conditioners w/Heat Pump & Solar Panel
- SOC - Exterior Paint Request
- (8) Exterior Graphics Packages (Carefree Electric Awning Included in Graphic Package/Entry Door Awning is not Stationary)
- Chrome "Bus Style" Heated Mirrors w/Remote Adjustments
- 36" Tray Package
- 54" Tray Package
- 90" Tray Package

Standard Features

Interior

THROUGHOUT

- Whole Coach Water Filtration System

DRIVER CONVENIENCE

- Centralized Control Panel Display Center at Entry

GALLEY

- Dometic® 120V/LPG Electric 12 Cu. Ft. Side by Side Refrigerator w/Icemaker

BEDROOM

- Fabric Padded Decor Wall Treatment (38X, 40C, 40J & 40L)
- Shoe Storage in Ward Closet

BATHROOM

- Residential China Bowl Flush Toilet w/Hand Sprayer (38X, 40C, 40E-Front Toilet Only, 40J & 40L)

Exterior

AUTOMOTIVE

- 4-Point Leveling Jacks
- (4) 12-Volt House Maintenance Free AGM Batteries (Group 27)

BODY STRUCTURE

- Liberty Chassis
- Light Weight Aluminum Wall Construction

STORAGE

- Drop In Pin Retention System for the Side Hinged Luggage Doors

- 38" Hardwood Dinette Table & 2 Flexsteel® Chairs & 2 Folding Chairs

- 60" x 80" Full Queen Bed Mattress (38X, 40C, 40J & 40L)

- Vacuum Flushed Toilet (40E Rear Bath only)
- Molded Shower Seat (38X, 40J & 40L)

- Chrome "Bus Style" Heated Mirrors w/Remote Adjustments
- Side Radiator Configuration

- Electro-Coated Platform Structure
- Steel Surface on Front Bulkhead/Engine Frame

- Side Hinged Compartment Bay Storage Doors

- 60" x 80" Radius Corner Bed Mattress (40E)

- Flip Down Shower Seat (40C & 40E)

- Trailer Hitch Receiver 15,000 lbs./Spartan®

- Interlocking Extrusions (Floor and Roof)

Options Revolution LE

THROUGHOUT (INTERIOR)

- Central Vacuum System w/Accessory Kit
- SOC – Interior Request
- Vented Washer/Dryer Unit
- Flexsteel® Ultraleather J-Style Sofa

DRIVER CONVENIENCE

- CB Radio Ready
- GPS Navigation System w/Sony® Color Back-up Monitor
- OnStar® Navigation System (First year subscription included)
- Visteon® In Dash CD – 6 w/Sirius® Satellite Radio (First year subscription included)
- Flexsteel® Ultraleather Passenger Wider Seat/6-Way Power/Electric Footrest

BEDROOM

- Ceiling Fan
- Bedroom Base Cabinet & Overhead

GALLEY/LIVING ROOM

- Norcold® 120V/LPG Electric 4-Door 12 Cu. Ft Refrigerator w/Icemaker
- Recessed 3 Sealed Burner Range w/Oven & Solid Surface Covers
- Facing Dinette
- CSA Recessed 3 Sealed Burner Range w/Oven & Solid Surface Covers

AUTOMOTIVE

- Spartan® Modular Chassis w/400 HP Cat® C9 Engine
- CSA Spartan® Package

THROUGHOUT (EXTERIOR)

- In-Motion TracVision® Domed Digital Satellite System
- Rear Rock Guard w/Logo
- Exterior Entertainment Center (20" Panasonic® TV w/Swivel Slide Out Tray)
- Dual 13.5 M Roof Air Conditioners w/Heat Pump & Solar Panel
- (16) Exterior Graphics Packages (Carefree Electric Awning Included in Graphic Package/Entry Door Awning is not Stationary)
- SOC- Exterior Paint Request
- "A" Tray Package (2) 90"
- "B" Tray Package (2) 54", (2) 36"
- "C" Tray Package (1) 90", (1) 54", (1) 36"
- "D" Tray Package (1) 54" & (1) 36"

IMPORTANT — PLEASE READ: Product information, photography and illustrations included in this publication were as accurate as possible at the time of printing. For further product information and changes, please visit our website at www.fleetwoodrv.com or contact your local Fleetwood dealer. Prices, materials, design and specifications are subject to change without notice. All weights, fuel, liquid capacities and dimensions are approximate. Fleetwood has designed its recreational vehicles to provide a variety of uses for its customers. Each vehicle features optimal seating, sleeping, storage and fluid capacities. The user is responsible for selecting the proper combination of loads (i.e. occupants, equipment, fluids, cargo, etc.) to ensure that the vehicle's capacities are not exceeded.

Weights and Measurements

SPARTAN® CHASSIS	REVOLUTION			REVOLUTION LE				
	38B	40C	40D	38X	40C	40E	40J	40L
Engine Displacement (Liters)	7.2	7.2	7.2	8.8	8.8	8.8	8.8	8.8
Wheelbase (Inches)	252	266	266	254	278	278	266	266
GVWR (lbs) ¹	32,000	32,000	32,000	34,000	34,000	34,000	34,000	34,000
Front GAWR (lbs) ²	12,000	12,000	12,000	14,000	14,000	14,000	14,000	14,000
Rear GAWR (lbs) ²	20,000	20,000	20,000	20,000	20,000	20,000	20,000	20,000
Base Weight (lbs) ³	25,300	25,600	26,200	27,900	28,000	28,200	N/A	N/A
GCWR (lbs) ⁴	42,000	42,000	42,000	49,000	49,000	49,000	49,000	49,000
Hitch Rating Weight (lbs)*	10,000	10,000	10,000	15,000	15,000	15,000	15,000	15,000
Tongue Weight (lbs)*	1,000	1,000	1,000	1,500	1,500	1,500	1,500	1,500
Fuel Capacity (gal)	125	125	125	125	125	125	125	125

DIMENSIONS AND CAPACITIES

Overall Length ⁵	38' 9"	39' 11"	39' 11"	39' 5"	40' 11.5"	40' 11.5"	39' 11.5"	39' 11.5"
Overall Height (with A/C)	12' 6.5"	12' 6.5"	12' 6.5"	12' 10"	12' 10"	12' 10"	12' 10"	12' 10"
Overall Width (maximum) ⁶	101"	101"	101"	101"	101"	101"	101"	101"
Interior Height (maximum)	84"	84"	84"	84"	84"	84"	84"	84"
Interior Width (maximum)	96"	96"	96"	96"	96"	96"	96"	96"
Fresh Water Holding Tank (gal)	95	95	95	95	95	95	95	95
Grey Water Holding Tank (gal)	60	60	60	60	60	60	60	60
Black Water Holding Tank (gal)	40	40	40	40	40	40	40	40
Appliance LPG Tank (gal) (WC) ⁷	38	50	50	38	38	38	38	38
Water Heater Tank (gal)	10	10	10	10	10	10	10	10

Liquid Weight Reference: Water (gal) = (8.3 lbs/3.8 kgs). Fuel (gal) = (7.1 lbs/3.2 kgs) LPG (gal) = (4.2 lbs/1.9 kgs).

Metric Conversion: Multiply pounds x 0.453 to obtain kilograms. Multiply gallons x 3.785 to obtain liters.

REVOLUTION

Model: Spartan® Chassis	Transmission: Allison® 3000 MH, 6-Speed w/Electronic Shifter
Engine: Cat® C7	Alternator Amps: 160 Amp Leece Neville
Torque: 860 lb.-ft. @ 1600 RPM	Horsepower: 350 HP

REVOLUTION LE

Model: Liberty Chassis	Transmission: Allison® 3000 MH, 6-Speed w/Electronic Shifter
Engine: Cat® C9	Alternator Amps: 160 Amp Leece Neville
Torque: 1150 lb.-ft. @ 1400 RPM	Horsepower: 400 HP

- GVWR (Gross Vehicle Weight Rating): Means the maximum permissible loaded weight of the motor home. The GVWR is equal to or greater than the sum of the unloaded vehicle weight plus the net carrying capacity.
- GAWR (Gross Axle Weight Rating): Means the maximum permissible loaded weight a specific axle is designed to carry.
- Base Weight: Means the estimated weight of the motor home without fuel, options, water, cargo or passengers.
- GCWR (Gross Combined Weight Rating): Means the value specified by the motor home manufacturer as the maximum allowable loaded weight of this motor home with its towed vehicle. Towing and braking capacities may differ. Refer to Fleetwood and chassis manufacturer manuals for complete information.
- Length taken from front bumper to rear bumper (excludes accessories).
- Excludes safety equipment and awnings.
- Tank Manufacturer's listed water capacity (WC). Actual LPG capacity is 80% of water listing as required by the safety code.

* The chassis manufacturer recommends the installation of a supplemental brake control system to activate the brakes on the vehicle or trailer you are towing.
N/A = Not available at time of printing.



Setting the Standard in Motor Home Quality.

Fleetwood® prototypes are exposed to thousands of miles of durability testing. Those components that don't survive are redesigned until they do. This sets our standard in safety and durability.

Reliable TuffPEX® plumbing runs throughout each vehicle creating a durable seal on all internal tubing. TuffPEX® assures water flow and functions in the coldest of temperatures. The TuffPEX® system is an industry leader in quality plumbing.

To assure a strong, weather-resistant structure, Fleetwood Vacu-bonds® all sidewalls, floors and ceilings to durable aluminum or steel frames. The Vacu-bond® process is unmatched by many competitors.

Fleetwood sinks and shelves are designed to handle full-size kitchenware. Few competitors can say the same.

Name Brand Components. Spartan®, Dupont®, Panasonic®, GE®, Flexsteel®, Moen®, Onan®, Norcold® and Dometic® to name a few. We gather the best name brands in the industry to create a superior coach for you.

What Drives You?

Maybe it's feeling like you're the only one on Earth. Perhaps it's the unique sense of closeness with the great outdoors. Or, it might be the joy that comes from spending quality time with family and friends. Whatever the reason, we know that you have a strong drive to experience everything that comes with spending time on the road. And for more than 50 years, we've shared that passion with you. Because we're RV enthusiasts ourselves, you can see our passion in the vehicles we design and build. Own a Fleetwood, and you'll feel like you're not just traveling, but embarking on an experience unlike any other. Set your own course for adventure and get out there and explore the world around you. Once you do, you'll see what it is that drives us — it's you.

RV OWNERCARE* is a limited one-year/15,000-mile and three-year/50,000-mile structural warranty, whichever occurs first, and it is fully transferable for the first 12 months. RV OWNERCARE is one of the RV industry's most comprehensive programs and includes systems, appliances, components and construction, with no deductible and no service charge. RV OWNERCARE coverage is provided from a company that will be around in the future to service your needs. See your nearest Fleetwood dealer for a full explanation of benefits and restrictions.

CLUB FLEETWOOD As a Fleetwood owner, you're eligible to become a member of our owners' group, Club Fleetwood. It's a perfect way to meet other Fleetwood owners who love to travel to beautiful resorts and vacation spots all across America. Call (877) 577-2560 and join the fun! Or visit www.fleetwood.com/clubs to learn more.

FLEETWOODRV.COM To locate a dealer near you, visit our website or call 1-800-444-4905. We can also be contacted at Fleetwood Customer Relations, P.O. Box 7638, Riverside, CA 92513-7638.

IMPORTANT—PLEASE READ Product information, photography and illustrations included in this publication were as accurate as possible at the time of printing. For further product information and changes, please visit our website at www.fleetwoodrv.com or contact your local Fleetwood dealer. Prices, materials, design and specifications are subject to change without notice. All weights, fuel, liquid capacities and dimensions are approximate. Fleetwood has designed its recreational vehicles to provide a variety of uses for customers. Each vehicle features optimal seating, sleeping, storage and fluid capacities. The user is responsible for selecting the proper combination of loads (i.e. occupants, equipment, fluids, cargo, etc.) to ensure that the vehicle's capacities are not exceeded.

Your local Fleetwood dealer is:



www.fleetwoodrv.com

*For complete info see your Fleetwood dealer. © 2004. Fleetwood Enterprises, Inc.
Printed in the USA. Inventory control number REV05F3 11/04.

