

05 Sunova®





29R Cypress Point

05 Sunova | Move on up.

Take a look at the value and amenities offered in the 2005 Itasca Sunova and you'll agree that this is your year to make the move to Class A convenience. No other motor home in its price range can match the durability and craftsmanship you get from a motor home built by Winnebago Industries®. The Sunova incorporates our SmartSpace™ design philosophy that makes the most of interior living areas by maximizing functionality and focusing on user-friendly features. These include the hoop-base swivel/glider chair, 24" TV, RV Radio®, QuickPort™ service connection hatch, TrueLevel™ holding tank monitoring system and the OnePlace® systems center. Finally, Class A luxury is an affordable reality.

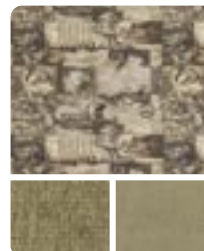

Cypress Point



Quarry Ash

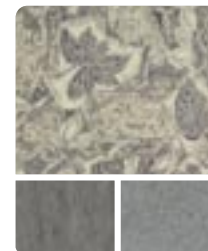

Ocean Pacific



Portsmouth
Oak

☛ The Itasca Sunova is the perfect introduction to Class A motor homes. Every model incorporates a front slideout to give you more living space. And you'll relax in comfort and style thanks to upscale features like Stitchcraft furniture and abundant Portsmouth Oak cabinetry. Additional comfort is provided by an available heat pump so you can warm your coach on cool mornings without using the furnace. The available dual-glazed, thermo-insulated windows offer increased thermal efficiency. Day/night pleated shades are also available for added privacy.



Everything you need for creating a full-course meal or a quick snack can be found in the galley, including a Magic Chef® three-burner range/oven, microwave and a two-door refrigerator/freezer. There's also plenty of countertop workspace thanks to the convenient sink covers and flip-up countertop extension (NA 34A). Abundant storage space is found in the cabinets and the pantry, which may include pullout trays or adjustable shelves. Pantries on the 27C and 30B (shown above) can be converted into a wardrobe, another example of how SmartSpace design can enhance your motor home experience.



The bedroom offers you all the comforts of home with a queen-size bed with a Serta® mattress and abundant storage in the wardrobe and cabinets. The available 13" TV is positioned for optimal viewing and is connected to the video selection system so you can easily choose between network, digital satellite or available DVD/VCR programming.*

* Digital satellite programming requires the available satellite dish, digital satellite receiver and programming subscription.



Sometimes you just want to spend an evening in your coach. With a 24" stereo TV, video selection system and available satellite system,* the Sunova provides endless entertainment options. Upgrade with a DVD/VCR combo or the Home Theater Sound System which includes an amplifier, receiver, five recessed speakers, subwoofer and DVD/VCR combo. Choose the available 300 watt inverter and you can enjoy your entertainment options even when you are not connected to shoreline power. The Stitchcraft furniture is quite relaxing, especially the high-back cab seats. They swivel, slide and have a fixed lumbar support and multiple recline adjustments for your comfort. The hoop-base lounge chair (NA 29R) also glides, swivels and can be set anywhere in the coach once you've reached your destination.



The dinette converts into a comfortable sleeping area and includes additional seat belts to give you greater seating flexibility while traveling. A child safety seat tether anchor is located in the forward facing dinette seat.



Driving is one of the joys of owning a Sunova. That experience is enhanced with large, easy-to-reach dash controls that are clearly labeled so they can be identified at a glance. The available rearview monitor provides peace of mind when backing or maneuvering.



Winnebago Industries engineers worked with the radio manufacturer

to create the RV Radio. The buttons and knobs are large and easy to use. It includes an AM/FM stereo, CD player, hand-held remote and steering wheel mounted remote, cassette deck and a weather band for instant weather updates at the touch of a button.



Relax outdoors while you listen to your favorite music on the available exterior entertainment center. It includes an AM/FM stereo, CD player, speakers, 12-volt powerpoint, TV jack and a removable table.



Tired of tripped electrical circuits? The PowerLine® energy management system monitors electrical usage and cycles appliances on and off to keep demand from exceeding supply. This fully automated system allows you to run two roof air conditioners on a 30 amp. shoreline connection and is standard on 33L, 34A and 35N.



Enjoy the added convenience of two-way radios. Each radio has up to a five-mile range and recharges from the house batteries in the built-in charging station.



QuickPort. You'll appreciate the convenience of the exterior service center. It includes a QuickPort™ service connection hatch which features an opening for hoses and power cords so you won't have to wrestle cords or hoses through small openings again. With QuickPort you can even close the compartment door when you are connected to hookups at the campground. The holding tank is heated and a winterization valve lets you extend your camping season. An exterior wash station is also available for easy cleanups.

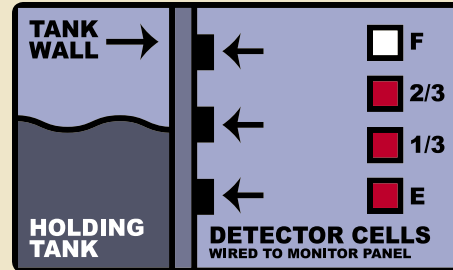

TRUELEVEL HOLDING TANK MONITORING SYSTEM

Winnebago Industries exclusive TrueLevel™ holding tank monitoring system incorporates Mirus™ detector cell technology to ensure accurate fresh and waste-water tank level readings. Mirus detector cells produce a micro-electrical field that detects liquid levels from outside the tank. No more probes to corrode or clog. Just true, accurate readings time after time.



The StoreMore® slideout system is a Winnebago Industries original design and still a benchmark of slideout innovation. StoreMore allows the exterior compartments to extend with the slideroom for easy access. Best of all, the exterior compartments are large enough to accommodate your oversized and odd-shaped items.



ONE PLACE™

The OnePlace systems center places important gauges and controls in a single wall panel for convenience and ease of operation.

05 Sunova | FLOORPLANS

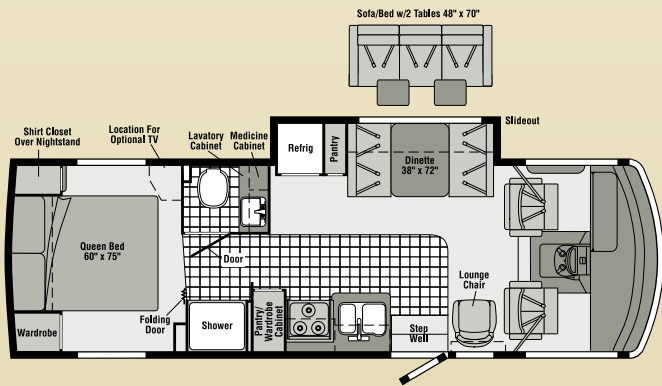

27C

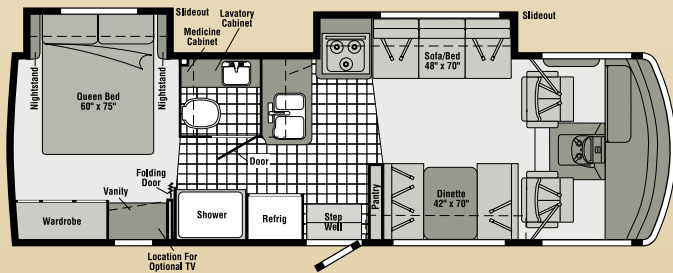

29R NEW

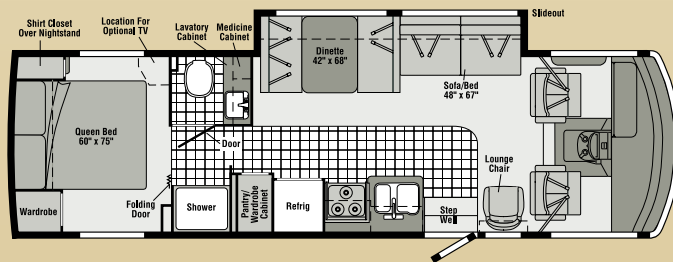

30B

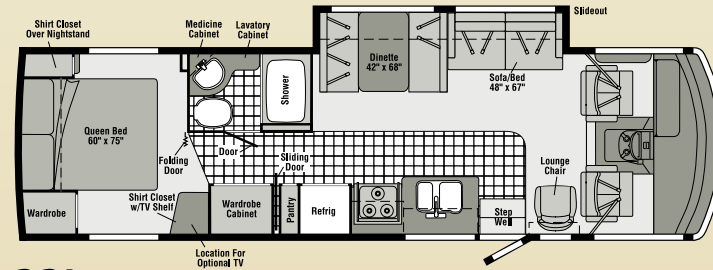

33L

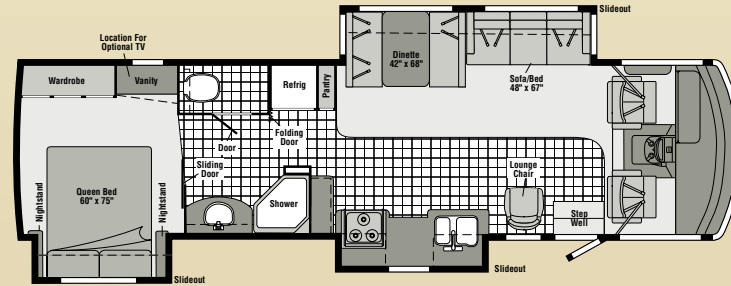

34A NEW
Available December 2004

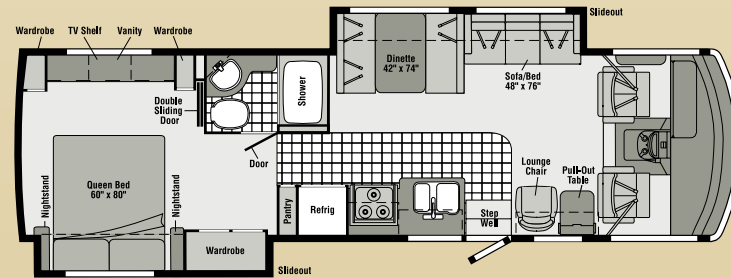

35N



Vinyl Floorcovering



Seat Belts

Note: Dimensions shown are for sleeping space only and may vary due to styling differences. Dashed lines denote overhead storage areas.

EXTERIOR DESIGN

The one-piece fiberglass sidewalls on the Sunova provide a high-gloss finish that looks great for years. Upgrade the standard wheel covers to stainless steel wheel liners for a more sophisticated appearance. Beneath the shiny exterior, the Sunova is loaded with basement storage.



05 Sunova | SPECIFICATIONS

Weights & Measures	27C	29R NEW	30B	33L	34A NEW	35N
Length	27'11"	29'8"	30'10"	33'2"	34'6"	35'2"
Exterior Height¹ – F / W	11'11"	12'1"	12'1"	12'1" / 12'0"	12'2"	12'2"
Exterior Width²	8'6"	8'6"	8'6"	8'6"	8'6"	8'6"
Exterior Storage³ (cu. ft.)	83.5	81.2	105.8	115.9	95.1	120.2
Interior Height	6'8"	6'8"	6'8"	6'8"	6'8"	6'8"
Interior Width	8'1"	8'1"	8'1"	8'1"	8'1"	8'1"
Fresh Water Capacity w/Heater⁹ (gal.)	72	77	72	71	75	71
Holding Tank Capacity⁹ – Black / Gray (gal.)	41 / 57	37 / 42	41 / 57	41 / 46	41 / 57	44 / 42
LP Capacity⁴ (gal.)	18	18	18	18	18	18
Fuel Capacity – F / W (gal.)	NA / 40	75 / 75	75 / 75	75 / 75	75 / 75	75 / 75
GCWR – F / W (lbs.)	NA / 19,000	26,000 / 22,000	26,000 / 22,000	26,000 / 22,000	26,000 / 26,000	26,000 / 26,000
GVWR – F / W (lbs.)	NA / 15,000	18,000 / 18,000	18,000 / 18,000	18,000 / 18,000	20,500 / 20,700	20,500 / 20,700
GAWR – F / W – Front (lbs.)	NA / 6,000	7,000 / 6,000	7,000 / 6,000	7,000 / 6,000	7,000 / 7,500	7,000 / 7,500
GAWR – F / W – Rear (lbs.)	NA / 11,000	11,000 / 12,000	11,000 / 12,000	11,000 / 12,000	13,500 / 13,500	13,500 / 13,500
Wheelbase	168"	190"	190"	208"	228"	228"

F Ford® W Workhorse™

27C	29R	30B	33L	34A	35N	Automotive
	S	S	S	S	S	Chassis – Ford® 6.8L SOHC Triton® V10 310-hp, 4-speed overdrive transmission, 4-wheel anti-lock hydraulic brakes, 130-amp. alternator
S	O	O	O			Chassis – Workhorse™ 8.1L Vortec V8 340-hp, 4L85-E 4-speed overdrive transmission, 4-wheel anti-lock hydraulic brakes, 145-amp. alternator
				O	O	Chassis – Workhorse™ 8.1L Vortec V8 340-hp, Allison® 1000 5-speed overdrive transmission, 4-wheel anti-lock hydraulic brakes, 145-amp. alternator
S	S	S	S	S	S	Tire spare, Tire Tools wrench & leverage bar, Trailer Hitch⁵ 5,000-lbs. draw bar/350-lbs. maximum vertical tongue weight & wiring, Wheelcovers (4)
O	O	O	O	O	O	Leveling Jacks hydraulic front & rear, w/touch pad control, Kwikkee®
O	O	O	O			Shocks/Stabilizer Package⁸ front
O	O	O	O	O	O	Wheel Liners stainless steel

27C	29R	30B	33L	34A	35N	Cab Area & Driver Conveniences
S	S	S	S	S	S	AC Duplex Receptacle, Beverage Holder passenger side, Cab Seats (fabric) w/3-point shoulder & lap seat belts w/retractors, armrests, lumbar support (fixed), multi-adjustable slide/recline & swivel, Cigarette Lighter/12-Volt DC Powerpoint, Convenience Tray w/cupholders, Cruise Control, Map Lights, Map Pocket, Steering Wheel tilt w/power assist, Sunvisors, Trim Panel driver-side w/cupholder, storage tray & bubble level indicator, Window (driver & passenger) partial slider w/screen, Windshield Wipers intermittent
O	O	O	O	O	O	Defroster Fans (2) auxiliary 2-speed w/instrument panel switch

27C	29R	30B	33L	34A	35N	Cab Area & Driver Conveniences
O	O	O	O	O	O	Monitor System rearview w/single camera & one-way audio, Audiovox®

27C	29R	30B	33L	34A	35N	Entertainment
S	S	S	S	S	S	CB Wire Prep,  (Cab) AM/FM Stereo/Cassette/CD, speakers (4), remotes (2), Radio Antenna roof mount, rubber, Radio Power Switch main/auxiliary battery, Satellite System Ready, TV 24" Color AC stereo w/remote, Video Selection System, cabinet, TV Enhancement Package antenna (amplified), 12-volt DC powerpoints, interior jacks, coax wiring, cable input, splitter

O	O	O	O	O	O	DVD/VCR Stereo Combo⁹ w/remote
O	O	O	O	O	O	Entertainment Center (Exterior) CD player, 12-volt DC powerpoint, AC duplex receptacle, AM/FM radio, TV jack, radio antenna, speakers (2), lockable compartment, removable TV table
O	O	O	O	O	O	Home Theater Sound System⁹ amplifier, DVD/VCR combo, receiver, recessed speakers (5), subwoofer
O	O	O	O	O	O	Radios (4) 2-way, charging station
O	O	O	O	O	O	Satellite Dish Antenna RV digital, manual
O	O	O	O	O	O	TV 13" Color DC w/remote, Video Selection System, bedroom

27C	29R	30B	33L	34A	35N	Interior
S	S	S	S	S	S	Blinds mini (lounge, dinette, galley), Ceiling fabric, Clock, Curtain front wraparound w/track, Lights reading, adjustable halogen (overheads), Lights ceiling, incandescent w/wall switches, Roof Vent nonpowered lounge, Shades pleated (bedroom), 12-Volt DC Powerpoint lounge
O	O	O	O	O	O	Roof Vent powered, ventilator fan, lounge
O	O	O	O	O	O	Shades day/night pleated (lounge, dinette, bedroom)
S	S	S	S	S	S	Wainscoting w/chair rail
O	O	O	O	O	O	Windows dual-glazed/thermo-insulated, flush-mounted

27C	29R	30B	33L	34A	35N	Cabinetry
S	S	S	S	S	S	Portsmouth Oak

27C	29R	30B	33L	34A	35N	Countertops
S	S	S	S	S	S	Laminate w/T-mold edging

27C	29R	30B	33L	34A	35N	Floorcovering
S	S	S	S	S	S	Carpeting w/pad, Vinyl bath & galley

27C	29R	30B	33L	34A	35N	Furniture
S	S	S	S	S	S	Dinette w/access to storage below
O						Sofa w/storage below, tables (2)
	S	S	S	S	S	Sofa w/storage below, throw pillow
					S	Lounge Chair hoop-base, swivel/glider, cabinet w/table, magazine rack
S	S	S	S			Lounge Chair hoop-base, swivel/glider

27C	29R	30B	33L	34A	35N	Galley
S	S	S	S	S	S	Faucet single-control, Microwave Oven Samsung® Pantry, Range Hood vented w/light & fan, Range 3-burner (one high-output) w/oven, Magic Chef® Refrigerator/Freezer double-door, Sink recessed, molded, double-bowl w/sink cover (countertop material), Wall Border
S	S	S	S		S	Countertop w/flip-up extension
	S					Glass Partition
				S		Storage Cabinet

27C	29R	30B	33L	34A	35N	Bath
S	S	S	S	S	S	Cabinets lavatory, medicine, Faucet (lavatory) dual-control, Faucet (shower) dual-control w/flexible showerhead, Light shower, Roof Vent powered, Shower w/removable clothes rod, Shower Door(s) textured glass, Shower Skylight , Sink , Tissue Holder , Toilet w/foot-pedal flush & sprayer, Towel Rack 3-rod, mounted to door, Wall Border
S	S	S				Mirror frameless w/beveled edge
	S					Towel Bar

27C	29R	30B	33L	34A	35N	Bedroom
S	S	S	S	S	S	Bed queen, innerspring, w/underbed storage, Bedsread pillow shams, throw pillow, Lights decorative wall lamps, Nightstand(s) , Picture(s) framed, TV Shelf , Wall Border , Wardrobe Cabinet(s) carpeted shelf, clothes rod
S	S	S				Headboard
S	S					Shirt Closet
			S			Shirt Closets (2)
	S			S	S	Vanity Cabinet

27C	29R	30B	33L	34A	35N	Exterior
S	S	S	S	S	S	Awning Rails w/rain gutters, Door entrance w/separate screen door, deadbolt lock, Entrance Door Steps double, electric w/doorjamb switch, Graphics Package Sandstone, Grille aluminum w/logo, Light porch w/interior switch, Mirrors manual adjust w/convex, Mudflaps front, Receptacle AC duplex, Sidewall Skin one-piece smooth fiberglass, Storage Compartments valance panels, gas strut, single-paddle latch, lights, trunk liner, KeyOne™ System
0	0	0	0	0	0	Awning patio
0	0	0	0	0	0	Ladder
0	0	0	0	0	0	Mirrors electric/remote w/defrost
0	0	0	0	0	0	Undercoating Workhorse™

27C	29R	30B	33L	34A	35N	Systems
S	S	S	S	S	S	Automotive Heater/Air Conditioner, Auxiliary Start Circuit, Batteries (Coach) (2) Group 24 deep-cycle, Battery (Coach) disconnect system, Battery Charge Control automatic dual, Electrical Distribution System AC breakers, DC fuses/breakers, 45-amp. converter/charger, ONEPLACE™ Systems Center wall-mount, energy management display (33L, 34A & 35N only), battery condition gauge, generator hourmeter gauge, generator start/stop switch, holding tank levels, LP tank level, water heater switch & lights, water pump switch, water tank level, Power Cord 30-amp., Service Center city water hookup/tank diverter fill, drainage valves, QuickPort™ service connection hatch, cable input, power cord, portable satellite hookup, sewer hose 10', Tank holding, heated compartment, Tank LP, permanent mount w/gauge, TRUELEVEL™ holding tank monitoring system, Water Heater 6-gallon, electronic ignition, LP gas, Water Pump demand, Water System Winterization Package bypass valve, water heater, Water Tank Fill gravity
S	S	S				Air Conditioner (Roof) 14,800 BTU, ceiling-ducted w/wall thermostat
			S	S	S	Air Conditioners (2) (Roof) high-efficiency, ceiling-ducted w/wall thermostat
0	0	0				Air Conditioner w/heat pump (Roof) 14,800 BTU, ceiling-ducted w/wall thermostat
			0	0	0	Air Conditioners w/heat pump (2) (Roof) high-efficiency, ceiling-ducted w/wall thermostat
S	S	S				Furnace 30,000 BTU, low profile, ducted, in-floor
			S			Furnace 35,000 BTU, low profile, ducted, in-floor
			S	S		Furnace 40,000 BTU, low profile, ducted, in-floor
S	S	S				Generator 4,000 watt, Onan® MicroQuiet™ gas
			S	S	S	Generator 5,500 watt, Onan® Marquis Gold™ gas
0	0	0	0	0	0	Inverter DC/AC, 300 watt
			S	S	S	POWERLINE™ energy management system
0	0	0	0	0	0	Wash Station exterior, w/pump switch located in service center
0	0	0	0	0	0	Water Heater 6-gallon, electronic ignition w/motoraid & auxiliary auto heater

27C	29R	30B	33L	34A	35N	Slideouts
	S			S		Slideout Room bed w/slideroom cover
					S	Slideout Room bed/wardrobe w/slideroom cover
				S		Slideout Room galley w/slideroom cover, STOREMORE®
S						Slideout Room dinette/refrigerator/pantry w/slideroom cover, STOREMORE®
	S					Slideout Room sofa/range w/slideroom cover, STOREMORE®
		S	S	S	S	Slideout Room sofa/dinette w/slideroom cover, STOREMORE®

27C	29R	30B	33L	34A	35N	Safety
S	S	S	S	S	S	Assist Bar interior, Assist Handle exterior, Bumpers front & rear, Child Seat Tether Anchor , Detectors/Alarms LP leak, smoke, carbon monoxide, Fire Extinguisher 10 B.C., Ground Fault Interrupter , Brake Light center, high-mount, Seat Belts cab, 3-point, Seat Belts lap (in selected areas), Window escape, Windshield laminated safety glass

27C	29R	30B	33L	34A	35N	Warranty ⁶
S	S	S	S	S	S	12-month/15,000-mile basic warranty⁷; 36-month/36,000-mile warranty on structure⁷; 10-year limited parts-and-labor warranty on roof skin⁷

- The height of each model is measured to the top of the tallest standard feature and is based on the curb weight of a typically equipped unit. The actual height of your vehicle may vary by several inches depending on chassis or equipment variations. Please check with your dealer for further information.
- Sunova floorplans feature a wide-body design — over 96". In making your purchase decision, you should be aware that some states restrict access on some or all state roads to 96" in body width. Before making your purchase decision, you should confirm the road usage laws in the states of interest to you.
- The load capacity of your motor home is designated by weight, not by volume, so you cannot necessarily use all available space when loading your motor home.
- Capacities shown are tank manufacturer's listed water capacity (W.C.). Actual filled LP capacity is 80% of listing due to overfilling prevention device on tank.
- Actual towing capacity is dependent on your particular loading and towing circumstances which includes GVWR, GAWR, and GCWR as well as adequate trailer brakes. Please refer to the Operator's Manual of your vehicle for further towing information.
- See separate chassis warranty details provided in owner's packet.
- See your dealer for complete warranty information.
- Not all items available in combination. See dealer for details.
- Capacities are based on measurements prior to tank installation. Slight capacity variations can result due to installation applications.

NA Not Available

S Standard

0 Optional

Winnebago Industries™ continuing program of product improvement makes specifications, equipment, model availability and prices subject to change without notice. Comparisons to other motor homes are based on the most recent information available.

SUPER STRUCTURE

Not all motor homes are created equal. SuperStructure® is the term given to Winnebago Industries' structural motor home design and construction. Rather than a single component, it is the culmination of design integration that incorporates steel and aluminum sub-structures, composite-design laminated floor risers, interlocking joint technology and Thermo-Panel® floor, roof and sidewalls to form an incredibly strong, durable vehicle body.

A Tubular steel risers feature a truss-design core for superior strength and provide a stable base for the floor structure and storage compartments.

B Critical steel components are treated using an advanced electrodeposition coating process that provides superior corrosion protection.

C The foundation substructure assembly is precision-aligned to maximize longitudinal and cross-coach support, as well as strength and durability.

D The all-steel cab features integral A and B pillars for added strength and stability.

E Windshields are mounted in steel with non-hardening sealants for superior strength, safety and durability. Some manufacturers actually use a rubber gasket to hold the windshield to a fiberglass cab.

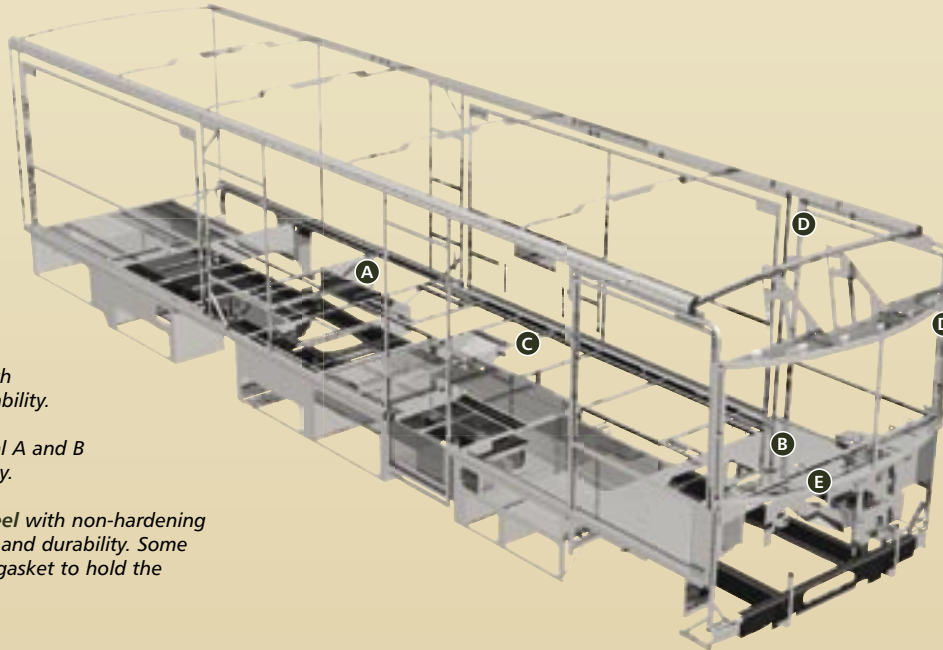

Interlocking joint construction utilizes advanced aluminum structural components to create integrated floor-to-sidewall and sidewall-to-roof joints. This design effectively distributes the weight of the walls and roof, making a stronger and more durable body than competitor designs that require screws to carry the weight.

We invented Thermo-Panel® sidewall construction and, over the years, have perfected this innovative composite construction process. It combines an exterior fiberglass panel, high-density block foam insulation and welded aluminum support structures to create some of the strongest, most durable and lightweight sidewalls in the industry.

Built to a higher standard. The Sunova features a crowned, one-piece fiberglass roof, backed with a 10-year limited parts-and-labor roof skin warranty. Fiberglass offers superior strength, attractiveness and durability over the rubber roofs found on many competitive models which can chalk, streak and degrade over time. Fiberglass also provides increased puncture and tear resistance.



1-year-old Itasca fiberglass roof



1-year-old competitor's rubber roof



Committed to service. We back our motor homes with the industry's best service after the sale.

- 12-month/15,000-mile basic limited warranty
- 36-month/36,000-mile warranty on structure
- Standard 10-year limited parts-and-labor roof skin warranty
- Complimentary 24-hour roadside assistance program
- TripSaver Fast Track Parts. TripSaver guarantees that in-stock warranty parts ship directly to your dealer within 24 hours.
- National dealer service network



Recognized quality. Recreation Vehicle Dealer Association members annually rate RV manufacturers on the quality of their products, and sales and service support. Winnebago Industries has achieved the coveted Quality Circle award every year since its inception, the only RV manufacturer to do so.



WARNING: Joining WIT has been known to cause excessive fun. Winnebago-Itasca Travelers (WIT) is a club for owners of Winnebago Industries motor homes. WIT is a great way to meet people and offers you:

- Caravans and rallies
- Local and state group activities
- RV travel benefits

winnebagoind.com
NYSE listing: WGO

For Sales and Service Information Contact:



©2004 Winnebago Industries, Inc.



Printed in USA

Seat belts are your most important hookup. Always buckle up.