

REVOLUTION LE -Floor Plans, Standard Features and Options



REVOLUTION LE



REVOLUTION LE-Class A Diesel-2006



Standard Features

Interior

THROUGHOUT

- 84" Interior Ceiling Height
- Deluxe Roller Bearing, Full Extension Drawer Guides
- Denso® Climate Control System
- Fabrica® Carpeting
- Power Vent w/Rain Sensors (All Vents, Galley, Bath & Shower Area)

- Whole Coach Water Filtration System
- 12V Fluorescent Ceiling Lighting
- Choice of Walnut, Regency Cherry or Clear White Maple Cabinetry
- Day/Night Pleated Shades
- Direct Spark Ignition 10 Gallon Water Heater 120V/Propane

- Entry Step Switch at Entry Wall
- Padded Vinyl Ceiling
- Solid Core Raised Panel Upper Cabinet Doors
- Solid Wood Drawers
- Tank Level Monitor (Interior Only)
- Tile Floor at Front Entry

DRIVER CONVENIENCE

- Adjustable Brake & Throttle Pedals
- Centralized Control Panel Display Center at Entry
- Flexsteel® Ultraleather™ Driver/Front Passenger Seats w/Manual Lumbar/6-Way Power
- Rear Vision System w/One-Way Audio (Camera & Monitor)
- Soft Touch Smart Wheel
- Tilt & Telescoping Steering Wheel w/Adjustable Dash Gauge Package

- Visteon® AM/FM Radio & Single CD Player
- (2) Auxiliary 12V Dash Receptacles
- (3) Power Driver/Passenger Sun Visors
- Auxiliary Fog Lights
- Auxiliary Start Switch
- Battery Disconnect Switch
- CB Radio Ready
- Cruise Control
- Driver Manual Side Pull Down Shade

- Driver's Window w/Slider
- Driver/Front Passenger Map Lights
- Flip Down Driver's Drink Holder
- I.C.C. Light Switch
- Manual Air Dump Switch
- Passenger Solid Surface Drink Holder
- Pneumatic Step Well Cover w/Lighted Stepwell Area

LIVING ROOM

- 27" TV
- Flexsteel® Ultraleather™ Love Seat
- Flexsteel® Ultraleather™ Sofa Bed
- Home Theater System

- w/DVD Player
- TracVision® Domed Digital Satellite System
- 4-Head Hi-Fi VCR

- Park Telephone Ready
- TV Cable Ready

GALLEY

- Base Cabinet Storage for the Range & Galley Sink Covers
- GE® Convection Microwave Oven w/Built In Range Hood
- High Rise Galley Faucet w/Pullout Sprayer
- Large 70/30 Split Solid Surface Sink
- Norcold® 120V/Propane Electric Stainless Steel 12 cu. ft. 4-Door

- Refrigerator w/Icemaker
- Satin Polished Solid Surface Galley Countertop
- Satin Polished Solid Surface Range & Sink Covers
- 120V Outlet & Telephone Jack at Dinette
- Ceramic Tile Backsplash
- Ceramic Tile Flooring w/Accent (Laid Diagonally)

- Hardwood Dinette Table, 2 Flexsteel® Chairs & 2 Folding Chairs
- Recessed 3 Sealed Burners Cook Top (Black Acrylic Finish)

BEDROOM

- 60" x 80" Full Queen Bed Mattress
- Cedar Lined Wardrobe
- Shoe Storage in Ward Closet
- 20" TV w/Swivel
- 60" x 80" Full Queen Bed

- Mattress (40J & 40L)
- 60" x 80" Radius Corner Bed Mattress (40E)
- Day/Night Pleated Shades
- DSS 2nd Receiver Ready-Bedroom Area (Coax Cable)

- Fabric Padded Decor Wall Treatment (40J & 40L)
- Satin Polished Solid Surface Nightstand and Base Cabinet Countertops
- Second Phone Jack

BATHROOM

- Moen® Hand Held Shower Head
- Residential China Bowl Flush Toilet w/Hand Sprayer (40E-Front Toilet Only, 40J & 40L)
- Satin Polished Solid Surface Lavy Top w/Porcelain Bowl & Moen® Faucet

- Vacuum Flushed Toilet (40E Rear Bath only)
- Ceramic Tile Flooring
- Deluxe Medicine Cabinet
- Flip Down Shower Seat (40E)
- Molded Shower Seat (40J & 40L)

- Shower Door w/Obscure Glass
- Skylight in Shower

SAFETY / CONVENIENCE

- Back-Up Alarm
- Carbon Monoxide Detector/Alarm

- Centralized Control Panel Display Center
- Fire Extinguisher

- Propane Detector/Alarm
- Smoke Detector/Alarm

40J Triple Slide-Out Sleeping Accommodations: 4*

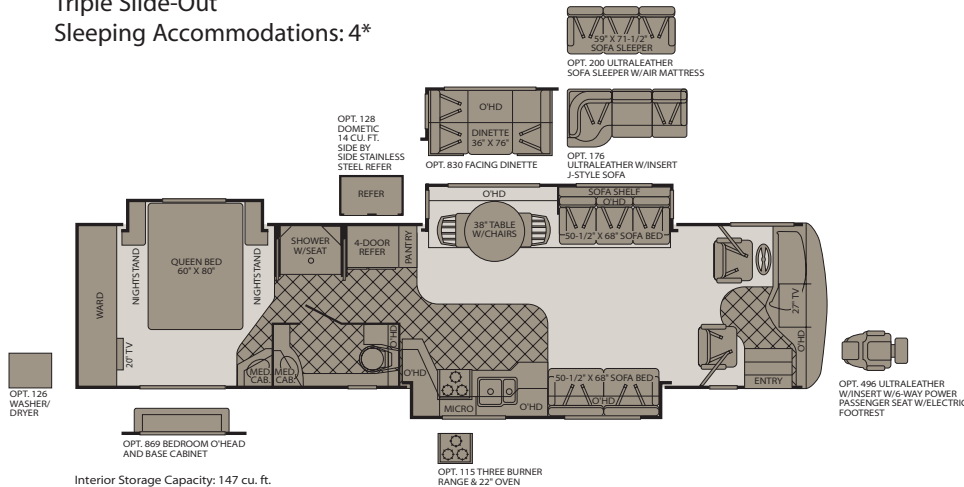

Interior Storage Capacity: 147 cu. ft.
Exterior Storage Capacity: 205 cu. ft.

*Sleeping accommodations are based on designed sleeping areas and may be greater than Sleeping Capacity Weight Rating (SCWR) found on the Cargo Carrying Capacity label located in each RV. Sleeping accommodations are based on standard layout. Optional furniture may increase or decrease sleeping accommodations.

Standard Features

Exterior

THROUGHOUT

- **Bus Style Large 50" Tall One-Piece Windshield**
- **Domed One-Piece Fiberglass Roof w/Radius Corners**
- **Dual Roof Mounted A/C High Efficiency w/Solar Panel on Front A/C**
- **Dual Pane Windows w/Screens**
- **Energy Management System (50 Amp)**
- **Onan® 7.5 kW Quiet Diesel Generator**
- **Window Awnings (Bedroom & Front Roadside Window)**
- (4) Aluminum Wheels
- (4) Mud Flaps
- 50 Amp Power Cord
- 2000 Watt Inverter

- Auxiliary Fog Lamps
- Battery Monitor
- Chrome "Bus Like" Heated Mirrors w/Remote Adjustments
- Dual Holding Tank San-T-Flush™ System
- Electric Patio Awning
- Electronic Battery Control Center
- European Style Automotive Headlights
- Exterior Convenience Light at Dump Valves
- Exterior Rinse Hose
- Fiberglass Front & Rear Quarter Panels
- Fiberglass Front Fascia
- Fiberglass Front/Rear Caps
- Fiberglass Molded Front Bumper
- Fiberglass Wheel Well Trims

- Fresh Water Gravity Fill
- Front Entry Door Awning
- Hadley® Air Horns (Bulkhead Mounted)
- Holding Tank w/Low Point Drain Valves
- Large Windshield Washer Bottle w/Sprayer Nozzles
- Multi-Point Water Pump Switching
- Park Telephone Ready
- Patio Receptacles
- Protective Front Vinyl Cover Without Logo
- Sound Insulation—Front & Rear
- Top Mounted Intermittent Wipers
- Two Piece Rear Ladder
- Utility Light—Front & Rear
- Variable Speed Aquatec Water Pump

AUTOMOTIVE

- **4-Point Automatic Leveling Jacks**
- **(4) 12-Volt House Maintenance Free AGM Batteries (Group 27)**
- **Allison® 3000 MH, 6-Speed Automatic Transmission**
- **15,000 lb Weight-Distributing Hitch Receiver w/7-Point Electrical Hook-up†**
- (2) 12V Chassis Batteries (1000 Cold Cranking Amps Each Battery)

- 160 Amp Alternator
- Anti-Lock Brake System (ABS)
- Full Air Brakes w/Automatic Slack Adjusters
- I-Beam Suspension w/Bilstein® Shocks
- Side Radiator Configuration
- Spartan® Modular Chassis w/400 HP Cat® C9 Engine
- Tire Pressure Check Gauge

† The chassis manufacturer recommends the installation of a supplemental brake control system to activate the brakes on the vehicle or trailer you are towing. Hitch receiver ratings expressed are maximum for the hitch receiver installed and may require the purchase of additional equipment that is dependant on the weight of the towed load. Consult with hitch receiver manufacturer for further information.

BODY STRUCTURE

- **Aluminum Interlocking Floor/Wall/Ceiling Framing**
- **Bonded One-Piece Windshield w/Steel Frame Support**
- **Electro-Coated Platform Structure**

- **Heated Water & Holding Tank Compartments**
- **Liberty Chassis**
- **Vacu-bond® Sidewall, Roof & Floor Construction**

- Steel Surface on Front Bulkhead/Engine Frame
- Vacu-bond® Insulated Storage Area

SAFETY / CONVENIENCE

- **Keyless Entry Remote**
- **Power Entry Step w/Last Out Feature**

- (4) Turn Signal Lamps on Each Side of Coach
- 30" Front Entry Door w/Dead Bolt

- Front & Rear Docking Lights
- Illuminated Entry Assist Handle
- Porch Lights (2)

STORAGE

- **Exterior Side Hinged Storage Doors (on Select Doors) w/Lockable Latch System & Drop Pin Retention System**

- Exterior Flip-Up Compartment Doors
- Lighted Luggage Compartments

Options

THROUGHOUT (INTERIOR)

- Automatic Generator Start System
- Central Vacuum System w/Accessory Kit
- Flexsteel® Ultraleather™ J-Style Sofa
- Vented Washer/Dryer Unit
- Ultraleather™ Sofa Sleeper w/Air Mattress

DRIVER CONVENIENCE

- Flexsteel® Ultraleather™ Passenger Wider Seat/6-Way Power/Electric Footrest
- GPS Navigation System w/Sony® Color Back-up Monitor
- Visteon® In Dash CD-6 w/Sirius® Satellite Radio (6 month subscription included)

BEDROOM

- Bedroom Base Cabinet & Overhead
- Bedroom Ceiling Fan
- Restonic® Rest-On-Air Dual Control Mattress

GALLEY

- CSA Recessed 3 Sealed Burner Range w/Oven & Solid Surface Covers
- Dometic® Side-by-Side Stainless Steel Refrigerator
- Facing Dinette
- Recessed 3 Sealed Burner Range w/Oven & Solid Surface Covers

THROUGHOUT (EXTERIOR)

- (16) Exterior Graphics Packages (Electric Awning Included in Graphic Package/Entry Door Awning is not Electric)
- A Tray Package (2) 90"
- B Tray Package (2) 54", (2) 36"
- C Tray Package (1) 90", (1) 54", (1) 36"
- D Tray Package (1) 54" & (1) 36"
- Dual Roof Mounted A/C High Efficiency w/Heat Pump and Front Solar Panel
- Exterior Entertainment Center (20" TV w/Swivel Slide-Out Tray)
- In-Motion TracVision® Domed Digital Satellite System
- Rear Rock Guard w/Logo
- Water Heater-16 Gallon Output

Revolution LE Advantages

- **84" Interior Ceiling Height**
- **Complete TuffPEX® Plumbing System**

- **Energy Management System (EMS) w/Soft Start**

- **Vacu-Bond® Upper/Lower Floors**

- **Liberty Chassis w/Patent Pending***

Bold Denotes Fleetwood's Key Features

**Denotes Fleetwood Exclusives*

IMPORTANT — PLEASE READ: Product information, photography and illustrations included in this publication were as accurate as possible at the time of printing. For further product information and changes, please visit our website at www.fleetwoodrv.com or contact your local Fleetwood dealer. Prices, materials, design and specifications are subject to change without notice. All weights, fuel, liquid capacities and dimensions are approximate. Fleetwood has designed its recreational vehicles to provide a variety of uses for its customers. Each vehicle features optimal seating, sleeping, storage and fluid capacities. The user is responsible for selecting the proper combination of loads (i.e. occupants, equipment, fluids, cargo, etc.) to ensure that the vehicle's capacities are not exceeded.

Weights and Measurements



SPARTAN® CHASSIS	40E	40J	40L
Engine Displacement (Liters)	8.8	8.8	8.8
Wheelbase (Inches)	278	266	266
GVWR (lbs) ¹	34,000	34,000	34,000
Front GAWR (lbs) ²	14,000	14,000	14,000
Rear GAWR (lbs) ²	20,000	20,000	20,000
Base Weight (lbs) ³	28,200	N/A	N/A
GCWR (lbs) ⁴	49,000	49,000	49,000
Hitch Rating Weight (lbs) [†]	15,000	15,000	15,000
Tongue Weight (lbs) [†]	1,500	1,500	1,500
Fuel Capacity (gal)	125	125	125

DIMENSIONS AND CAPACITIES			
Overall Length ⁵	40' 11.5"	39' 11.5"	39' 11.5"
Overall Height (with A/C)	12' 10"	12' 10"	12' 10"
Overall Width (maximum) ^{6,7}	101"	101"	101"
Interior Height (maximum)	84"	84"	84"
Interior Width (maximum)	96"	96"	96"
Fresh Water Holding Tank (gal)	95	95	95
Grey Water Holding Tank (gal)	60	60	60
Black Water Holding Tank (gal)	40	40	40
Appliance Propane Tank (gal) (WC) ⁸	38	38	38
Water Heater Tank (gal)	10	10	10

Liquid Weight Reference: Water (gal) = (8.3 lbs/3.8 kgs). Fuel (gal) = (7.1 lbs/3.2 kgs) Propane (gal) = (4.2 lbs/1.9 kgs).
Metric Conversion: Multiply pounds x 0.453 to obtain kilograms. Multiply gallons x 3.785 to obtain liters.

REVOLUTION LE	
Model: Liberty Chassis	Transmission: Allison® 3000 MH, 6-Speed w/Electronic Shifter
Engine: Cat® C9 @ 400 HP	Alternator Amps: 160 Amp Leece Neville
Torque: 1150 lb-ft @ 1400 RPM	Tires: Goodyear® 295/70R 22.5H

- GVWR (Gross Vehicle Weight Rating) is the maximum permissible weight of this fully loaded motor home. The GVWR is equal to or greater than the sum of the unloaded vehicle weight plus the cargo carrying capacity.
 - GAWR (Gross Axle Weight Rating) is the maximum permissible loaded weight a specific axle is designed to carry.
 - Base Weight is the estimated weight of the motor home without fuel, options, water, cargo or passengers.
 - GCWR (Gross Combined Weight Rating) is the value specified by the motor home manufacturer as the maximum allowable loaded weight of this motor home with its towed vehicle. Towing and braking capacities may be different. Refer to Fleetwood and chassis manufacturer's manuals for complete information.
 - Length taken from front bumper to rear bumper (excludes accessories).
 - Excludes safety equipment and awnings.
 - Motor homes feature a body-width over 96" which will restrict your access to certain roads. Before purchasing, you should research any state and/or province road laws which may affect your usage.
 - Tank manufacturer's listed water capacity (WC). Actual propane capacity is 80% of water listing as required by the safety code.
- † The chassis manufacturer recommends the installation of a supplemental brake control system to activate the brakes on the vehicle or trailer you are towing. Hitch receiver ratings expressed are maximum for the hitch receiver installed and may require the purchase of additional equipment that is dependant on the weight of the towed load. Consult with hitch receiver manufacturer for further information.
- N/A = Not available at time of printing.



Setting the Standard in Motor Home Quality.

Fleetwood® prototypes are exposed to thousands of miles of durability testing. Those components that don't survive are redesigned until they do. This sets our standard in safety and durability.

Reliable TuffPEX® plumbing runs throughout each vehicle creating a durable seal on all internal tubing. TuffPEX® assures water flow and functions in colder temperatures. The TuffPEX® system is an industry leader in quality plumbing.

To assure a strong, weather-resistant structure, Fleetwood Vacu-bonds® all sidewalls, floors and ceilings to durable aluminum or steel frames. The Vacu-bond® process is unmatched by many competitors.

Fleetwood sinks and shelves are designed to handle full-size kitchenware. Few competitors can say the same.

Name Brand Components. Spartan®, Dupont®, GE®, Flexsteel®, Moen®, Onan®, Norcold® and Dometic® to name a few. We gather the best name brands in the industry to create a superior coach for you.

What Drives You?

Maybe it's feeling like you're the only one on Earth. Perhaps it's the unique sense of closeness with the great outdoors. Or, it might be the joy that comes from spending quality time with family and friends. Whatever the reason, we know that you have a strong drive to experience everything that comes with spending time on the road. And for more than 50 years, we've shared that passion with you. Because we're RV enthusiasts ourselves, you can see our passion in the vehicles we design and build. Own a Fleetwood, and you'll feel like you're not just traveling, but embarking on an experience unlike any other. Set your own course for adventure and get out there and explore the world around you. Once you do, you'll see what it is that drives us — it's you.

RV OWNERCARE* is a limited one-year/15,000-mile coach warranty and three-year/50,000-mile structural warranty, whichever occurs first, and it is fully transferable for the first 12 months. RV OWNERCARE is one of the RV industry's most comprehensive programs and includes systems, appliances, components and construction, with no deductible and no service charge. RV OWNERCARE coverage is provided from a company that will be around in the future to service your needs. See your nearest Fleetwood dealer for a full explanation of benefits and restrictions.

FLEETWOOD TRAVELCADE CLUB As a Fleetwood owner, you're eligible to become a member of our owners' group, Fleetwood Travelcade Club. It's a perfect way to meet other Fleetwood owners who love to travel across America and share in the RV lifestyle. Call (877) 577-2560 or visit www.fleetwood.com/clubs to learn more and join the fun!

FLEETWOODRV.COM To locate a dealer near you, visit our website or call 1-800-444-4905. We can also be contacted at Fleetwood Customer Relations, P.O. Box 7638, Riverside, CA 92513-7638.

IMPORTANT—PLEASE READ Product information, photography and illustrations included in this publication were as accurate as possible at the time of printing. For further product information and changes, please visit our website at www.fleetwoodrv.com or contact your local Fleetwood dealer. Prices, materials, design and specifications are subject to change without notice. All weights, fuel, liquid capacities and dimensions are approximate. Fleetwood has designed its recreational vehicles to provide a variety of uses for customers. Each vehicle features optimal seating, sleeping, storage and fluid capacities. The user is responsible for selecting the proper combination of loads (i.e.: occupants, equipment, fluids, cargo, etc.) to ensure that the vehicle's capacities are not exceeded.

Your local Fleetwood dealer is:



www.fleetwoodrv.com

*For complete info see your Fleetwood dealer. ©2005. Fleetwood Enterprises, Inc. Printed in the USA. Inventory control number REVLE06F2 10/05.

