

2005 | ENDEAVOR®



This is Living®



HOLIDAY RAMBLER®

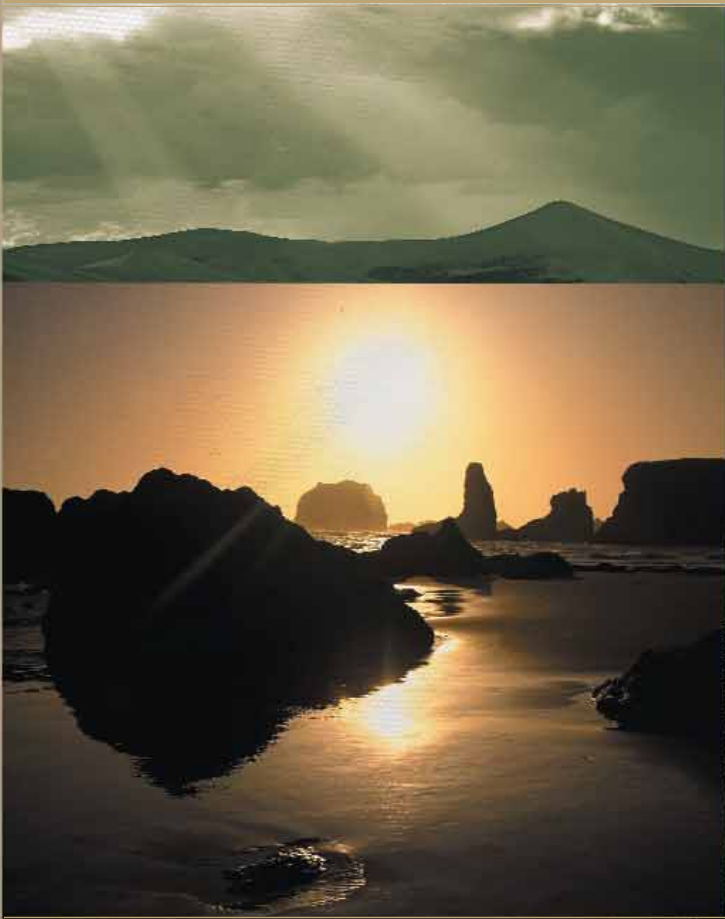



This is Living[®]

Fifty-one years. It's a proud reminder of our many accomplishments. After all, we were there from the start of an industry, and innovation by innovation we've led the way toward creating a rich and wonderful RV lifestyle.

Maybe it's not until you own a Holiday Rambler that you can truly feel the strength of our heritage. You'll feel it in the peace of mind you'll have knowing your family's in the safest RV on the road. You'll feel it in the quality of your experiences, thanks to the hundreds of conveniences we've developed. And you'll feel it when you realize you're free to roam throughout North America with confidence, knowing our network of support is with you every mile of the way.

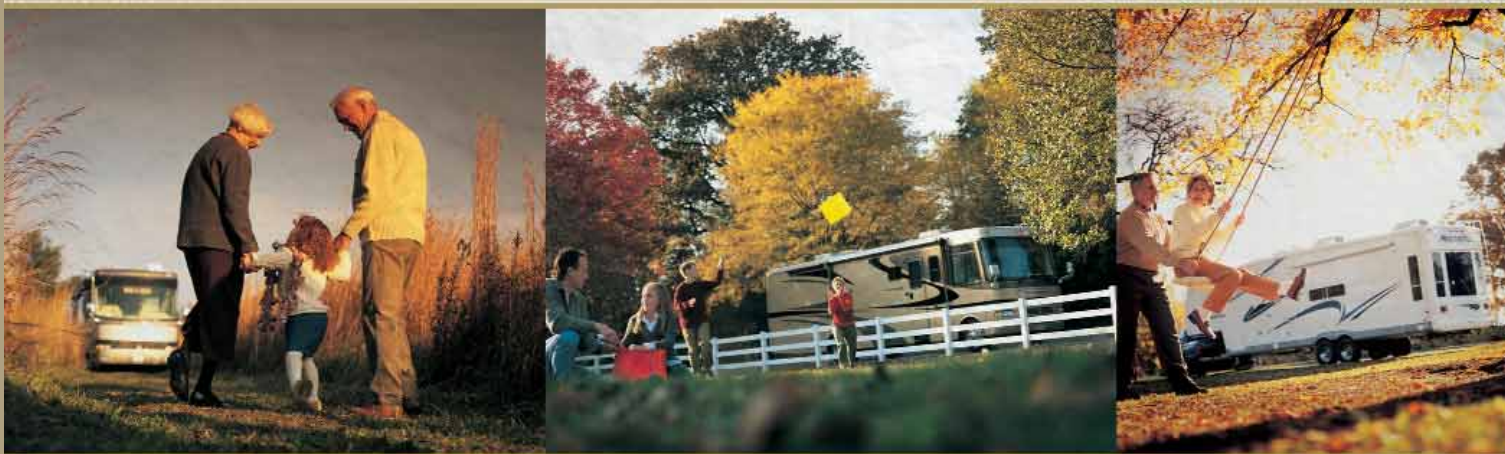

So join us as we look forward to a new model year. For 2005, we're celebrating an exciting new lineup, full of more groundbreaking products and high-tech advances than ever.



2005 ENDEAVOR

GETTING BETTER WITH EVERY YEAR.

How do you improve one of the most popular diesel coaches on the road? By fine-tuning the smallest details. By giving you more ways to customize your coach than ever before. And most importantly, by adding value — with numerous upgrades in styling and convenience. So come aboard. This winner still has the power to surprise you.



Holiday Rambler®

1954 - 2005



WINTER PALACE DECOR WITH VINTAGE OAK WOOD

40PDQ



PRAIRIE DECOR WITH MAPLE WOOD

40PDQ



EVERY DETAIL SAYS WELCOME HOME.

As you take a closer look at the Endeavor, you'll see many of the special touches that set it apart. Like its residential-style decor — with the craftsmanship of raised panel cabinet doors, crown molding, hardwood slide-out fascia and designer carpeting. You'll also love the convenience of the remarkable legless dinette table with solid surface top, two beautiful chairs and two handy folding chairs.

In the kitchen, you're greeted by the sleek, contemporary look of the solid surface countertop, and the workspace is highly organized, with a roll-out pantry, built-in sink covers and wastebasket storage. The high-quality appliances include a large double-door refrigerator and a versatile convection microwave.

The roomy bedroom features a large queen bed with hardwood headboard and fabric inserts. A dresser, nightstands and an oversized wardrobe closet provide plenty of storage space. And you'll love the new 20" flatscreen CRT stereo TV. To the left is the optional hide-a-bed with air mattress, giving you more sleeping room for family and guests.



The 2005 Endeavor boasts new deluxe full-body paint, for a showroom finish that will last for years to come.



{ LET THE ADVENTURES BEGIN. }

Looking toward the front of the coach, you can see the Endeavor's spacious cockpit. The pilot and co-pilot six-way power seats feature plush Ultraleather™ coverings and optional power footrests. Overhead, you'll find the new 24" flatscreen CRT stereo TV, wired through the ceiling speakers for superior sound quality. A home theater system makes an exciting option, and the optional VCR and DVD player are neatly tucked in overhead cabinets and conveniently wired to both TV locations.

The stylish bathroom features a solid surface vanity countertop with integrated sink and decorative mirror backsplash. The easy-to-clean one-piece fiberglass shower has a beautiful decorative glass door, and the 40DST model comes standard with a bathtub.

On the right, you can see some of the coach's exterior highlights, including the new side-hinged baggage doors, designed to give you easier access to your items stowed below. Other conveniences include the power heated mirrors mounted on the front cap, power sunvisors and the front cap generator access with slide-out tray.



The coach comes standard with a full complement of high-quality awnings, and you have the option of an Eclipse automatic patio awning.





PRAIRIE DECOR WITH MAPLE WOOD

40PDQ



ALUMAFRAME® CONSTRUCTION SINCE 1966:

The Endeavor features Holiday Rambler's exclusive Alumaframe® Superstructure. Our revolutionary system of aluminum C-Channel crossmembers runs the entire length of the unit, with double-welded intersections for added strength. This rigid design is both lighter and sturdier than wood or tubular aluminum frames — and much more reliable than butt-welded or screwed joint designs. From dirt roads to potholes, you can count on Alumaframe® to handle the relentless stresses of the road and provide superior structural integrity for many years to come.

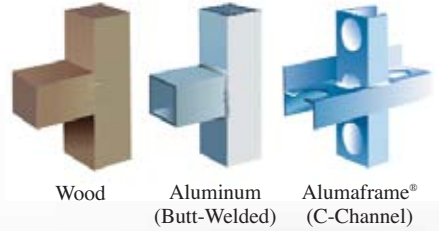

Alumaframe®



TRUSS SYSTEM WITH RUST INHIBITOR:

This steel truss system is engineered as part of the chassis and provides outstanding strength and rigidity plus pass-through storage. In addition, the structure is pre-primed and coated with a rust inhibiting paint.

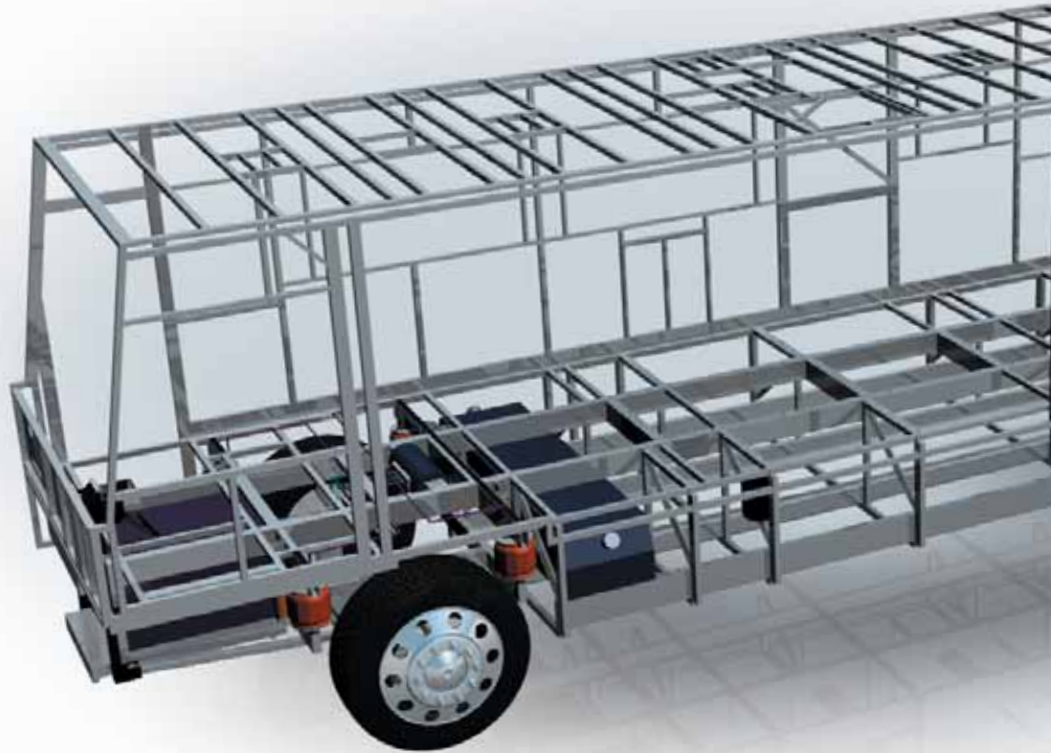

ROADMASTER RR8R-SERIES CHASSIS

ROOF CONSTRUCTION: (top to bottom)

- Peaked aluminum roof
- Luaun backing
- Thick, tapered bead foam insulation
- Aluminum double I-beam superstructure filled with fiberglass insulation
- Vapor barrier
- Structure foam: thermal insulative barrier
- 1/2" bead foam insulation
- Foam padding for extra insulation
- Padded vinyl ceiling



SIDEWALL CONSTRUCTION: (left to right)

- Gel coat fiberglass
- Interlocking C-Channel filled with 1-1/2" fiberglass insulation glued in place so it doesn't sag or leave spaces uninsulated
- Vapor barrier
- Bead foam saves energy and provides a thermal insulative barrier
- Interior paneling

**ENGINE MOUNTING:**

The three-point engine mounting system lowers the coach's center of gravity and reduces the amount of vibration that reaches the coach. The mounting also makes the engine easier to service.



CUMMINS® ISL 400 DIESEL ENGINE:
The Endeavor features a gutsy standard Cummins® ISL 400 diesel engine with Allison® 3000 MH 6-speed world transmission and electronic shifter.

**Roadmaster
Chassis**

The Roadmaster Raised Rail RR8R-Series chassis was designed specifically for Holiday Rambler's luxury coaches like the Endeavor, and it leads its class in sophisticated features that combine to provide a smooth ride and superior front-to-rear balance.

- Eight air bags work in conjunction with eight gas-powered shock absorbers to prevent road trauma from ever reaching the coach.
- Monitored leveling sensors continually adjust the air pressure at each axle to maintain a level ride and eliminate nosediving, weight transfer, and floating on curved roads. This system also stabilizes the coach on uneven surfaces.
- A 10,000 lb. tow hitch rating is the highest in its class.
- The exclusive raised rail design provides for larger full pass-through storage bays with flush floors.
- Other features include a 3/8" thick frame rail — compared to the 1/4" of other manufacturers — and a stacked aluminum intercooler and radiator for optimum heat transfer and cooling.

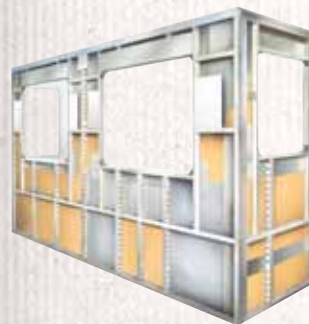
**SLIDE-OUT CONSTRUCTION:**

When you get a Holiday Rambler, you can be sure the slide-out boxes are some of the strongest and most reliable you'll find anywhere. They feature our exclusive multi-layer construction to give you maximum insulation and to reduce the chance of warping, twisting or shifting.

FLOOR CONSTRUCTION:
(top to bottom)

- Structurwood™
- 1-1/2" steel tube
- Blue foam
- Luaun
- Darco

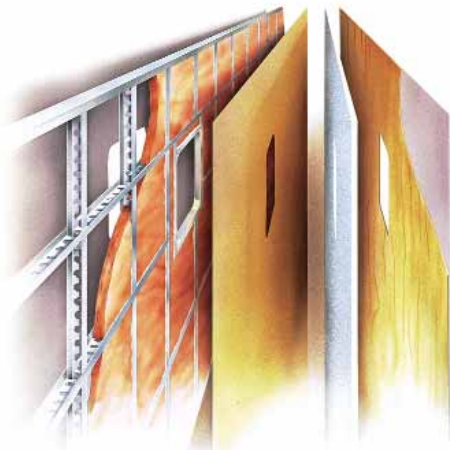
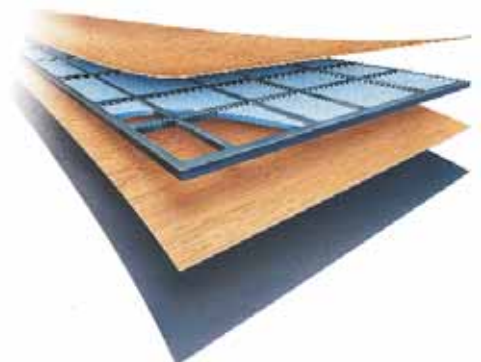



CELEBRATING THE FREEDOM OF CHOICE.

At Holiday Rambler, we're dedicated to giving you more ways to create the coach of your dreams. That's why the Endeavor features a wide selection of exciting double, triple and quad slide-out floorplans, with numerous furniture options to fit your lifestyle. In addition, our designers have created exquisite color and fabric combinations to give you the most beautiful interiors you'll find anywhere. Add to that the woodwork of your choice, and you'll have a luxurious coach you can truly call home.

A	B
	C
	D

- A Sofa
- B Accent
- C Bedspread
- D Carpet



BURNISHED PLATINUM



PRAIRIE



UMBRIA



WINTER PALACE



BLACKWOOD MANOR

featuring fabrics from Liz Claiborne



BETTER STAIN PROTECTION Manufactured in, not added on. For added protection against stains, Dupont Teflon® soil repellent is applied to virtually all upholstery fabric during the finishing process for superior coverage.*

*Brand and application of upholstery fabric protection may vary depending on date recreational vehicle was manufactured.



Vintage Oak



Autumn Cherry



Maple

**BODY CONSTRUCTION****STANDARD FEATURES**

- Alumaframe® Superstructure
- Steel Cage Cockpit Construction
- Peaked Aluminum Roof with Fiberglass Insulation
- Smooth Gel Coat Fiberglass Exterior Walls
- Front Molded Fiberglass Cap
- Rear Molded Fiberglass Cap with Integrated Air Intake
- One-Piece Generator Access Door
- Rear Engine Door Struts
- Angled Fiberglass Engine Cover
- Steel Framed Floor on Steel Trusses
- Laminated Structurwood™ Flooring
- Electric Flush Floor Stepwell Cover
- Interior Paneling with 3/4" Insulation
- Foam Insulated Floor Framing with Luaun Backer
- Power Heated Remote Exterior Mirrors
- Headlamp with Turn Signal
- Fog Lights
- Flush Mount Metal Fuel Doors
- Side-Hinged Baggage Doors, Storage Compartments Only
- One-Piece Polyethylene Pass-Through Storage Compartment
- Wheel Mud Flaps
- Deluxe Full-Body Paint
- HR Blue Dot to Front and Rear Caps
- Chrome Letter Decals
- Interior Entry Step Storage
- Roof Ladder
- Undercoating

OPTIONS

- Storage Bay Slide-Out Tray
- 17.5" Chrome Power Heated Mirror with Turn Signal
- Full-Length Mud Flap
- Slide-Out Battery Tray
- 3M® Film Front Mask

CHASSIS/ENGINE/SUSPENSION**STANDARD FEATURES**

- Roadmaster Raised Rail RR8R-Series Chassis
- Cummins® 400 HP ISL Engine with Allison® 3000 MH 6-Speed World Transmission and Electronic Shifter
- Aluminum Rear Mount Radiator with CAC Cooler
- Engine Displacement 8.9L/540 Cu. In.
- Torque: 1,200 lbs./ft. Max. Net at 1,300 RPM

- Dual Fuel Fill
- 160 Amp Alternator
- Rear Axle Ratio: 4.30:1
- Goodyear Radial Tires 275/70R/22.5 G670RV
- Stainless Steel Wheel Liners
- Cushion Air Glide Suspension with Eight Outboard Mounted Air Bags and Eight Monroe Shock Absorbers
- Anti-Lock Braking System with Full Air Brakes (Drum)
- Automatic Traction Control
- Exhaust Braking System
- Auto Slack Adjusters on Brakes
- Transmission Temperature Gauge
- Air Cleaner Restriction Gauge
- Engine Block Heater
- Fuel and Water Separator
- Remote Transmission Fill
- Rock Shield to Radiator
- 10,000 Lb. Hitch Receiver with Seven-Point Connector
- RVA Manual Hydraulic Leveling Jacks

OPTIONS

- Polished Aluminum Wheels

COCKPIT**STANDARD FEATURES**

- Automotive Dash with Beige IP
- Dash 12V Chassis Battery Gauge
- CD Player/Radio with Six Speakers
- Power Sunvisors
- Pleated Front Privacy Drape with Braided Tie Backs
- Wood Framed Cabinet Doors with Smoked Glass over Front Entertainment Center Systems
- Cockpit Front and Side Overhead Top-Hinged Cabinet Doors, Self-Supporting Hinges
- Adjustable Brake and Accelerator Pedals
- 110V, 12V and Phone Outlet
- Color Rear Vision System
- Lighted VIP Smartwheel® with Controls for Windshield Wipers, ICC and Cruise Control
- Intermittent Windshield Wipers
- 6 Quart Tank for Windshield Fluid with Fluid Sensor to Tank and "Low Wash" Indicator on Dash
- Audible Turn Signals
- Roof-Mounted Air Horn
- Two-Tier Cup Holders Center Console and Passenger Side Console



- CB Prep
- Ultraleather™ Pilot and Co-Pilot Seat with 6-Way Power Pilot Seat
- Power Steering
- Directional Map Lights on Bottom of Front TV Cabinet
- Color-Coordinated Carpeted Floor Mats

OPTIONS

- Ultraleather™ Six-Way Power Co-Pilot Seat
- Ultraleather™ Six-Way Co-Pilot Seat with Power Footrest
- Ultraleather™ Extra Wide Co-Pilot Seat with Power Footrest
- Pilot and Co-Pilot Pull-Down Sunshades
- 10 Disc CD Changer
- Dash Fans

APPLIANCES AND ACCESSORIES**STANDARD FEATURES**

- Large Double-Door Refrigerator
- High-Output Three-Burner Cooktop without Oven
- Removable Solid Surface Range Covers
- Spacesaver Convection Microwave
- 24" Flatscreen CRT Color Stereo TV with Remote Control in Living Area
- Living Area Stereo TV Wired through Ceiling Speakers
- 20" Flatscreen CRT Color Stereo TV with Remote in Bedroom Area
- TV Antenna with Jacks
- VCR Prep and Video Control Box with Booster
- Exterior Hook-Ups for DSS Dish and Cable
- Digital Satellite System Prep
- Interior Cable TV Hook-Up and Telephone Jacks
- VCR or DVD Player Options to be Wired to Both TV Locations
- Washer/Dryer Prep

OPTIONS

- Large Four-Door Refrigerator with Ice Maker (N/A with Pantry)
- High-Output Three-Burner Range with Oven
- Stainless Steel Microwave
- Combination Washer/Dryer
- DVD Player
- VCR
- Home Theater System with DVD/VCR Player
- 26" Flatscreen LCD TV in Living Area
- Exterior Entertainment Center without Label on Door (N/A: 40PAQ)
- Fully Automatic Digital Satellite System

INTERIOR**STANDARD FEATURES**

- Vintage Oak Cabinetry
- Raised Panel Hardwood Cabinet Doors
- Hardwood Cabinet End Panels
- Refrigerator Raised Panel Hardwood Inserts
- Decorative Wallboard
- Wallpaper Border in Bath
- Self-Supporting Top-Hinged Overhead Storage Doors and Positive Catches on All Other Doors
- Heavy-Duty Ball Bearing Drawer Guides
- Wood Cabinet Drawer Boxes
- Crown Molding in Bedroom and Living Area
- Metal Interior Grab Handle on Dash at Entry Door
- Satin Nickel Cabinetry Hardware and Bath Accessories
- Polished Solid Surface Kitchen Countertop with Stainless Steel Sink with Two Sink Covers
- Solid Surface Kitchen Countertop Extension
- Silverware Drawer with Organizer in Kitchen Base Cabinets (N/A: 36SKT)
- Tip-Out Tray under Kitchen Sink
- Solid Surface Backsplash with Decorative Inlay and Beveled Mirrors in Kitchen Galley
- Solid Surface Bathroom Countertop with Integrated Sink and Decorative Mirror Backsplash
- Solid Surface Dinette and Nightstand Tops
- Kitchen Overhead Cabinet with Adjustable Shelf
- Roll-Out Pantry next to Two-Door Refrigerator (N/A with Four-Door Refrigerator)
- Wastebasket Storage
- Sink and Stove Top Cover Storage Area inside Kitchen Base Cabinet
- Ceramic Tile in Kitchen and Bath
- Ceramic Tile in Front of Washer/Dryer Area
- Designer Carpeting in Living Area and Bedroom
- Soft Touch Padded Vinyl Ceiling
- Hardwood Slide-Out Fascia with New Decorative Center Block
- Decorative Hardwood/Fabric Window Boxes throughout Coach
- Hardwood Framed Headboard with Fabric Inserts
- Medicine Cabinet with Two Adjustable Shelves
- Towel Bars in Bathroom
- Oversized Rear Closet Wardrobe with Deluxe Decorative Mirror Doors and Frames in Satin Nickel
- Bedroom Dresser with Solid Surface Countertop
- Accent Mirror on Refrigerator Wall
- Bathroom Lavatory Mirror

continued



- Two Towel Rings in Bathroom
- Blackout Day/Night Pleated Shades in Living Area and Bedroom
- Mini Blinds in Kitchen and Bath
- Soil Repellant on Fabric, Teflon® Fabric Protection

OPTIONS

- New Decors: Prairie, Umbria, Winter Palace, Burnished Platinum
- Special Decor: Blackwood Manor Featuring Fabrics by Liz Claiborne
- Wood Choice: Autumn Cherry and Maple
- Tile Entry – Becomes Laminate When Laminate is Selected
- Laminate Plank Flooring Kitchen and Bathroom and in Front of Washer/Dryer Area
- Solid Surface Kitchen Sink

FURNITURE**STANDARD FEATURES**

- Legless Dinette Table with Two Chairs and Two Folding Chairs
- Roadside Furniture: Fabric Easy Bed Sofa
- Curbside Furniture: Fabric Barrel Chair (36SKT, 40PAQ)
- Curbside Furniture: Fabric Easy Bed Sofa (N/A: 36SKT, 40PAQ)
- Queen Bed (60" x 80") with Solid Surface Nightstands

OPTIONS

- Roadside Furniture: Fabric Hide-A-Bed with Air Mattress
- Roadside Furniture: Ultraleather™ Hide-A-Bed with Air Mattress
- Roadside Furniture: Fabric Magic Bed Sofa
- Roadside Furniture: Ultraleather™ Magic Bed Sofa
- Roadside Furniture: Ultraleather™ Easy Bed Sofa
- Roadside Wraparound Computer Desk with Euro-Recliner with Ottoman (N/A: 36SKT, 40DST, 40PAQ)
- Curbside Furniture: Fabric Hide-A-Bed with Air Mattress (N/A: 36SKT, 40DST, 40PAQ)
- Curbside Furniture: Ultraleather™ Hide-A-Bed with Air Mattress (N/A: 36SKT, 40DST, 40PAQ)
- Curbside Furniture: Fabric Magic Bed Sofa (N/A: 36SKT, 40DST, 40PAQ)
- Curbside Furniture: Ultraleather™ Magic Bed Sofa (N/A: 36SKT, 40DST, 40PAQ)
- Curbside Furniture: Ultraleather™ Easy Bed Sofa (N/A: 36SKT, 40DST, 40PAQ)
- Curbside Furniture: Ultraleather™ J-Lounge with Drawer (N/A: 36SKT, 40PAQ)
- Curbside Furniture: Fabric Recliner (36SKT, 38PDD, 40PAQ)
- Curbside Furniture: Ultraleather™ Recliner (36SKT, 38PDD, 40PAQ)
- Curbside Furniture: Ultraleather™ Euro-Recliner with Ottoman (36SKT, 38PDD, 40PAQ)

- Adjustable Coffee Table
- Pillow Top Mattress
- Booth Dinette (N/A: 40PAQ)

ELECTRICAL SYSTEMS AND LIGHTS**STANDARD FEATURES**

- 50 Amp 12V Distribution Panel and Power Cord
- Onan® 8.0 kW Quiet Diesel Generator on Manual Slide-Out
- Four 6V Deep Cycle Batteries
- Two 12V Heavy-Duty Chassis Batteries
- Battery Disconnect Switch at Front Door
- Battery Boost Switch in Cockpit
- 2,000 Watt Inverter
- Recessed Docking Lights
- Porch Light and Exterior Step Light on Same Switch
- Lighted Interior Steps
- Lights in Outside Storage Compartments with Switch on Passenger Console and Utility Bay
- 110V Receptacles in Outside Storage Compartment
- Underhood Utility Light
- Systems Control Center in Hallway
- Fluorescent Light(s) under Kitchen Overhead
- Fluorescent Ceiling Lights Throughout
- Decorative Satin Nickel Lighting Package
- Fluorescent Ceiling Lights inside Living Area Slide-Out House
- Decorative Framed Longer Galley Fluorescent Ceiling Light
- Halogen Lights with Dimmer Control under Living Room, Dining Room, Bed Overhead and Bedroom Dresser Overhead Cabinets

OPTIONS

- Energy Management System
- Auto Generator Start
- Solar Panel
- Power Cord Reel Located in Wet Bay

PLUMBING AND LP SYSTEMS**STANDARD FEATURES**

- Demand Water System and Water Pump
- 10 Gallon LP Gas/Electric Water Heater with Electronic Ignition DSI Water Heater Located below Floor
- Single Lever Kitchen Faucet with Pullout Sprayer
- Separate Brushed Satin Faucet for Filtered Water
- Satin Nickel Bathroom Faucet
- Satin Nickel Shower Faucet
- Water Heater Bypass Valve



- Water Pump Switch in Hall Systems Panel Center Private Bathroom Lavatory and Service Bay Area
- Thetford China Toilet
- Thetford China Toilet Electronic Thetford Silent Plus (40DST Only)
- Shower inside Wet Bay with Hot/Cold Water
- No-Fuss Flush Holding Tank Rinsing System
- Gravity and Pressurized Water Fill
- Insulated Systems Compartment with Easy Access to Hook-Ups
- One-Piece Fiberglass Shower (N/A: 40DST)
- Bathtub (40DST)
- Satin Aluminum Shower Door Frame with Decorative Glass
- Soap Dispenser inside Utility Bay

OPTION

- RV Sani-Con Tank Drainage System
- Electric Automatic Winterization
- Power Water Hose Reel
- Bathtub

HEATING, VENTS AND AIR CONDITIONING**STANDARD FEATURES**

- Dual 13.5M BTU Roof Air Conditioner with Ducted Air, Heat Pumps and Digital Thermostat Control
- Electronic Ignition Furnace (38PDD) – (1) 40M BTU (36SKT)
- Dual Zone Electronic Ignition Furnaces – (2) 25M BTU (N/A: 36SKT, 38PDD)
- Electronic Dash AC/Heat Climate Control System
- In-Floor Ducted Heating System
- 12V Fantastic Attic Fan in Kitchen
- 12V Roof Vents in Bath and Private Bath (N/A: 36SKT)
- 12V Heater in Wet Bay
- Metal Floor Registers Satin Nickel

OPTIONS

- 12V Fantastic Attic Fan in Lavatory
- Attic Fan with Rain Sensor Kitchen
- Attic Fan with Rain Sensor Lavatory

WINDOWS, DOORS AND AWNINGS**STANDARD FEATURES**

- Radius Flush Mount Dual Pane Safety Glass Dark Tinted Windows
- Front Entry Door with Removable Screen and Anti-Skid Steps
- Exterior Entry Door Grab Handle
- Metal Interior Grab Handle on Dash at Entry Door
- Color-Coordinated Acrylic Patio Awning
- Topper Slide-Out Awnings Living Area and Bedroom
- Front Door Awning
- Tinted Skylight in Bathroom with Protecta Glaze
- Window Awnings on All Slide-Out House Windows except Kitchen Window and Slide-Out Windows under Patio Awning

OPTIONS

- Eclipse Automatic Patio Awning
- Bedroom Window Awning on Sidewall (N/A: 38PDQ, 40PAQ, 40PDQ)
- Keyless Entry

SAFETY**STANDARD FEATURES**

- Fire Extinguisher
- Deadbolt Lock on Entrance Door
- 120V GFI Protected Circuit
- LP Gas Detector
- Smoke Detector
- Carbon Monoxide Detector
- Driver and Passenger Three-Point Seat Belts
- Third Brake Safety Light
- Egress Window(s)

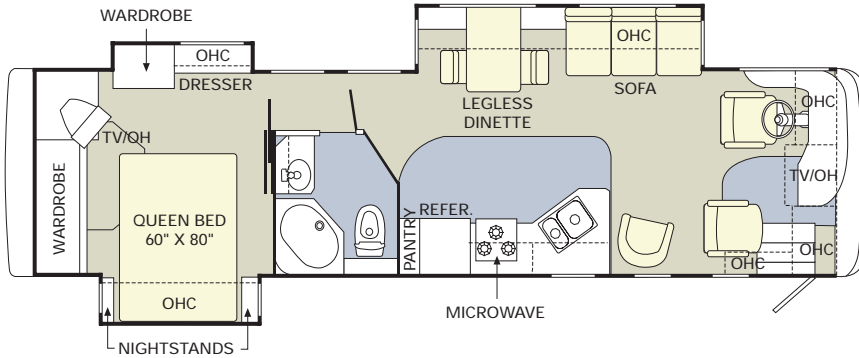

36SKT

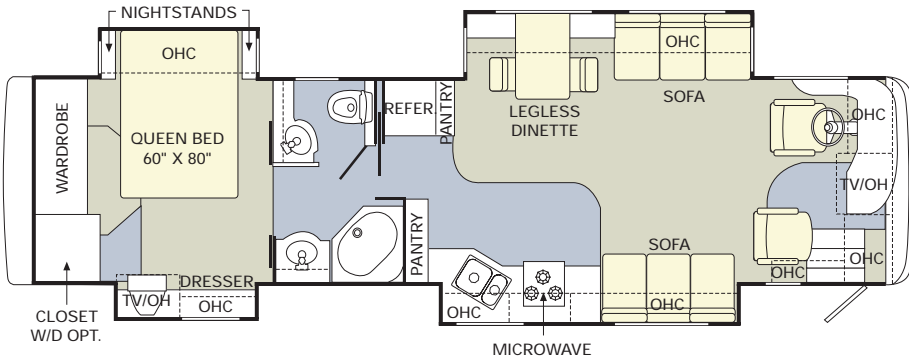

38PDQ

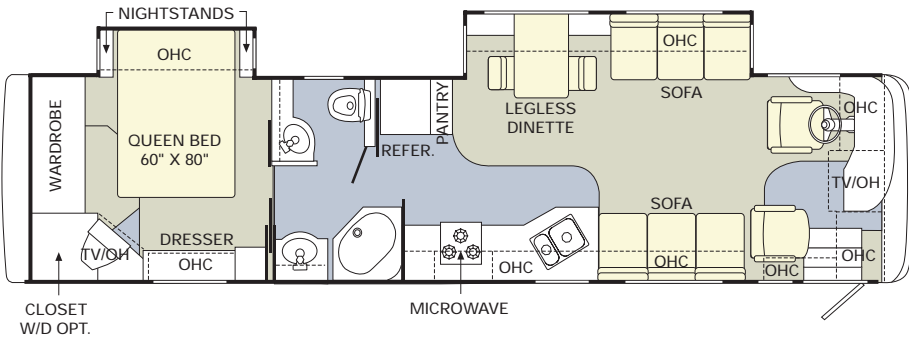

38PDD

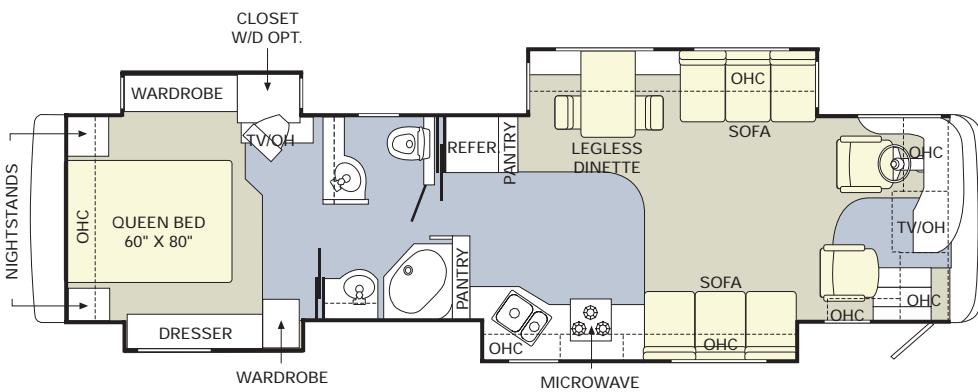

40PRQ

● CARPET

● TILE

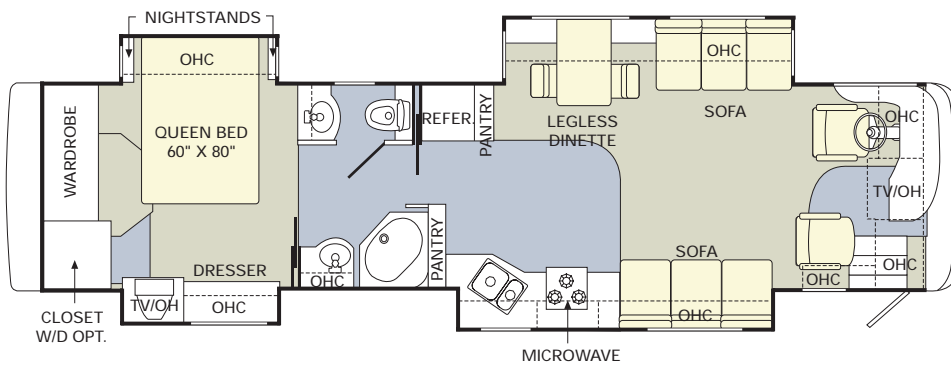
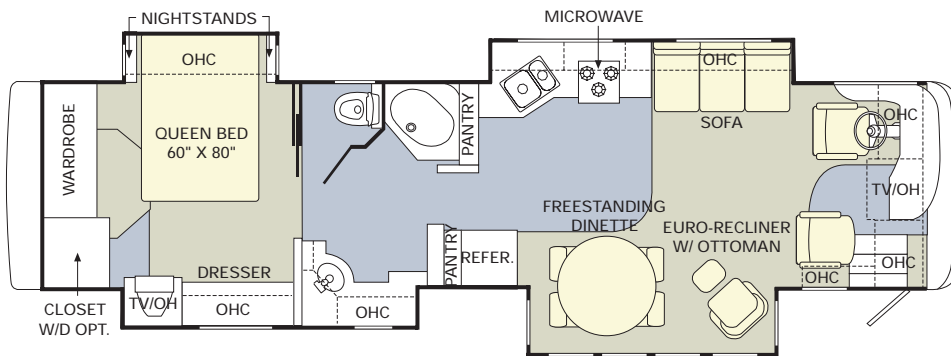
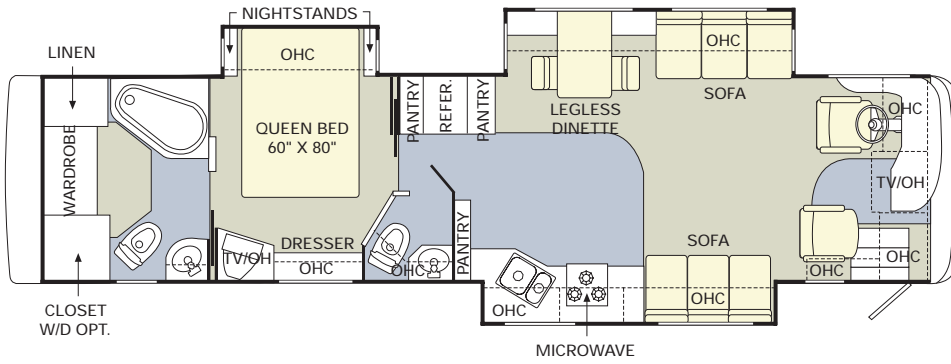



Weights	36SKT	38PDQ	38PDD	40PRQ	40DST	40PAQ	40PDQ
Gross Vehicle Weight Rating (Lbs.)	33,000	33,000	33,000	33,000	33,000	33,000	33,000
Gross Combined Weight Rating (Lbs.)*	43,000	43,000	43,000	43,000	43,000	43,000	43,000
Front Gross Axle Weight Rating (Lbs.)	13,000	13,000	13,000	13,000	13,000	13,000	13,000
Rear Gross Axle Weight Rating (Lbs.)	20,000	20,000	20,000	20,000	20,000	20,000	20,000

Measurements

Wheelbase	216"	242"	242"	256"	256"	256"	256"
Overall Length	36' 9"	38' 11"	38' 11"	40' 1"	40' 1"	40' 1"	40' 1"
Overall Height	12' 3"	12' 3"	12' 3"	12' 3"	12' 3"	12' 3"	12' 3"
Interior Height	81"	81"	81"	81"	81"	81"	81"
Interior Width	94.5"	94.5"	94.5"	94.5"	94.5"	94.5"	94.5"
Exterior Width	100.5"	100.5"	100.5"	100.5"	100.5"	100.5"	100.5"

Tank Capacities**

Water Heater (Gal.)	10	10	10	10	10	10	10
Grey Tank (Gal.)	62	62	62	62	62	62	62
Black Tank (Gal.)	40	40	40	40	40	40	40
Fresh Tank (Gal.)	100	100	100	100	100	100	100
Fuel Tank (Gal.)	100	100	100	100	100	100	100
LP Tank (Gal.)***	39	39	39	39	39	39	39

* Towing capacity is limited by GCWR; your vehicle's towing capacity is the difference between the GCWR and the actual vehicle weight, including all water, fuel, passengers and cargo. Your towed vehicle should be equipped with auxiliary brakes if the weight of the towed vehicle exceeds 1,000 lbs. Consult your Owner's Manual for further towing information.

** Variances in the fabrication and installation of the tanks may cause the actual "usable capacity" to be greater or less than the capacities designated above.

*** Actual filled LP capacity is 80% of listing due to safety shut-off required on tank.

Due to the large variety of options and floorplan arrangements available to our customers, actual weights for each unit can differ significantly. Holiday Rambler provides a weight sticker on each unit we produce which includes that unit's tank capacities and approximate weight. Consult your local Holiday Rambler dealer for unit availability and further information.

The information printed in this brochure reflects product design, fabrication, and component parts at the date of printing. The manufacturer reserves the right, at any time, to make changes in product design or material or component specifications as its sole option, without notice. This includes the substitution of components of a different brand or trade name, which will result in comparable performance. All information printed in this brochure is subject to change after the date of printing. Some features shown or mentioned in this brochure are optional and may only be available in selected floorplans. Photographs may show props or decorations that are not standard equipment on Holiday Rambler models. Holiday Rambler, the HR logo and its design, are registered trademarks. All other products and company names are trademarks and/or registered trademarks of their respective holders.

While the color of the motorhome's exterior and the interior fabrics depicted in this sales brochure are fair and reasonable depictions, the colors depicted may not be an exact match of the actual colors because of the variances in photo-processing and variances caused by inserting the photographs within the sales brochure. Due to product improvements, changes during the model year and/or transcription errors that may occur, information represented within this brochure may not be accurate at the time of your purchase. If certain information is significant to your purchasing decision, please confirm the information with your dealer prior to submitting your order.

The actual overall length of the recreational vehicle may differ from that indicated in the brochure due to variances in the manufacturing process and/or installed components. The actual length may be greater or less than that indicated.

Component part and appliance manufacturers issue limited warranties covering those portions of the recreational vehicle not covered by the Limited Warranties issued by the Monaco Coach Corporation companies. To learn more on what specific component parts and appliances are excluded from the Limited Warranties issued by the Monaco Coach Corporation companies please contact your selling dealership or Monaco Coach Corporation directly or review the warranty packet inside the recreational vehicle.



{ IT'S ALL ABOUT BUILDING A LASTING RELATIONSHIP. }

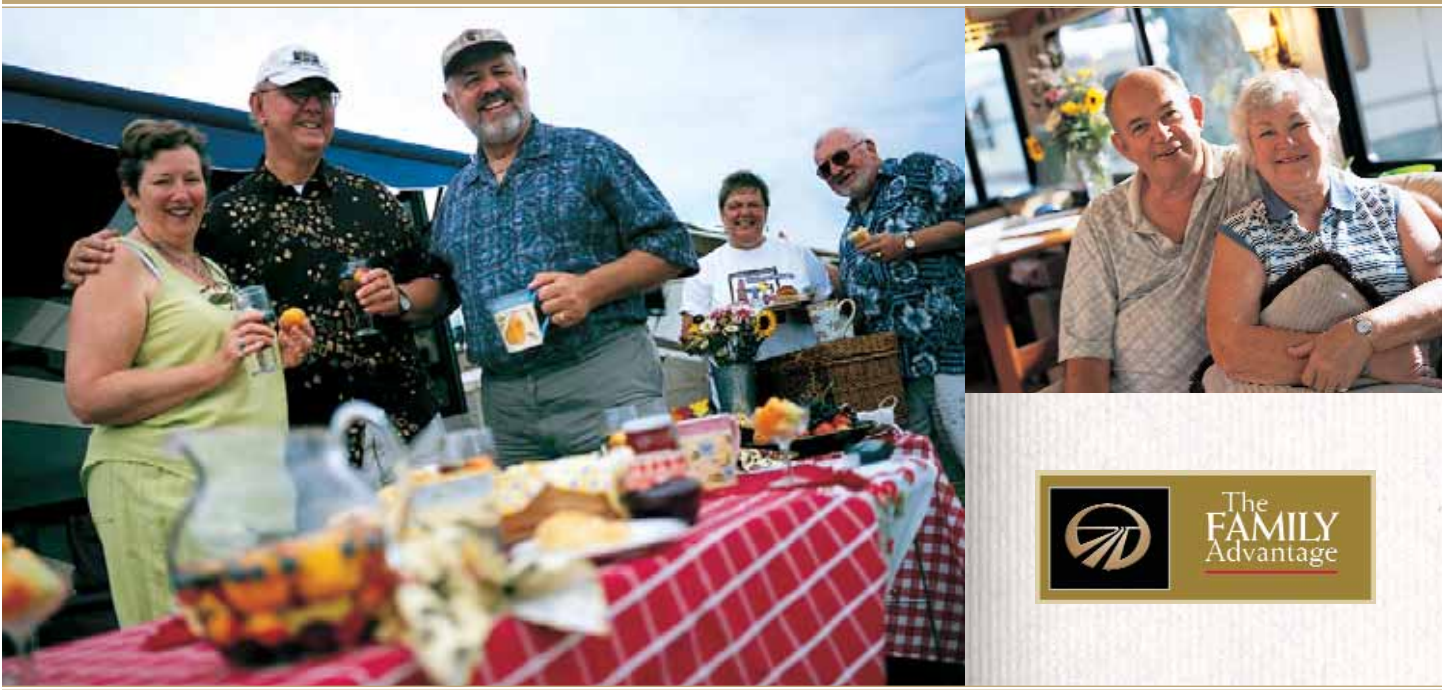

WELCOME TO THE FAMILY ADVANTAGE.

What is the Family Advantage? It's all the ways we put the strength of our family to work for yours. It's the unmatched level of teamwork, expertise and combined experience of all our companies. It's our industry-leading Roadmaster chassis and our remarkable White Glove factory inspection program.

It's our ability to respond rapidly to our owner's needs, with new features and technologies. And it's our commitment to value and to giving you more RV for your money.

The most important aspect of the Family Advantage is being there when you need us. Our staff is available 24/7/365 to help you with virtually any situation that may arise — with troubleshooting, operational instruction or facilitating repairs at the nearest of our 350 nationwide service centers. In addition, you will be enrolled in our Owner Advantage Roadside Assistance Program free of charge for your first year of ownership — providing additional emergency assistance, including towing, tire repairs and many more services around the clock. No matter where you are, someone is standing by to talk with you 24 hours a day — to help you get the most from your time on the road.

In short, when you purchase an RV from Monaco Coach Corporation, you get a wider array of benefits than any other manufacturer can offer. To see it all for yourself, call 1-800-634-0855 or 1-800-650-7337. We'd love to meet you Monday through Friday for a tour of one of our state-of-the-art production facilities in Oregon or Indiana.



350 | SERVICE FACILITIES
NATIONWIDE AND GROWING.

OWNER ADVANTAGE ROADSIDE ASSISTANCE PROGRAM

At no charge to you in your first year of ownership, we offer an extensive support program that provides complete roadside assistance and special motor club benefits that follow you wherever your travels take you. This coverage also includes one additional family vehicle at no extra charge! Highlights include towing, tire repairs, fuel delivery, lock-out service, service appointment assistance, trip interruption coverage and much more.

WARRANTIES

12 MONTH/24,000 MILE
basic limited warranty

5 YEAR/50,000 MILE
limited warranty on aluminum or steel frame structure
of sidewall, roof, front and rear cap

3 YEAR/36,000 MILE
limited warranty on Roadmaster chassis

Applies to certain models. See owner's manual for complete details.



2005 | ENDEAVOR®



This is Living®



HOLIDAY RAMBLER®

This is Living®

www.holidayrambler.com

(800) 245-4778

MONACO COACH CORPORATION

Monaco is traded on the New York Stock Exchange under the listing MNC
© 2004, Monaco Coach Corporation 1104 NPN:BROHEND Litho in USA.

MNC
LISTED
NYSE

