

20

NEPTUNE®

06



HOLIDAY RAMBLER®

This is Living®





THINKING DIESEL? WE'VE GOT THE ANSWER.

You're looking at the very best diesel value on the road — the 2006 Neptune. Not only does it give you the incomparable performance of the Roadmaster chassis, it's loaded with Holiday Rambler's legendary quality and styling. Plus, you get all the benefits of our unbeatable owner support — with technical assistance that's just a phone call away, 24/7/365. Welcome to the prestige of the diesel coach lifestyle. Thanks to the Neptune, it's well within reach.

TAKING VALUE TO NEW HEIGHTS.

At Holiday Rambler, we're continually seeking new ways to enhance the spaciousness of our interiors. This year, the Neptune features an increase in ceiling height to a full 7 feet. Now that's headroom! As you take a closer look, you'll also notice the many residential-style touches that make this coach a home. It all starts with the gorgeous woodwork, with hardwood raised panel cabinet doors, crown molding and decorative slide-out fascia. You'll also love the plush furnishings — with numerous options for customizing your floorplan to best fit your lifestyle.

A) Stylish comfort awaits you in the bedroom, with plenty of roomy storage to keep everything neatly stowed away. The queen bed features a wood-framed headboard with a padded fabric insert and is flanked by nightstands. You'll find built-in cabinet space for the optional 20" flatscreen TV, and the living room prep for a DVD player is also wired to this location.



THE HIGHLIGHTS OF THE HIGH LIFE.

The hub of your daily activities is the kitchen, where you'll find beautiful styling, exceptional storage space and top-notch appliances. The contemporary solid surface countertop offers plenty of seamless workspace and the stainless steel sink features a single-lever faucet with a pullout sprayer and a separate faucet for filtered water. Every nook and cranny is put to good use with many built-in storage spaces, including a roomy pantry. You'll love the convenience of the large double-door refrigerator with ice maker, as well as the versatile combination convection/microwave oven.



A) The brass shower frame and bathroom faucet complement the brass-finished hardware on the cabinets throughout the coach. The solid surface countertop and integrated sink make cleanups easy, and you'll find plenty of storage space in the medicine cabinet and vanity.

B) While a booth dinette comes standard, you may select this optional freestanding dinette with two stylish chairs, two folding chairs and a convenient wall cabinet.





THIS IS WHERE COMFORT AND SAFETY COME TOGETHER.

In a Holiday Rambler, the comfortable cockpit is also the safest you'll find anywhere. It all starts with the steel cage cockpit construction and steel firewall, for superior protection. And the six-way power pilot seat offers multiple adjustments to help you find the most comfortable posture and to reduce driver fatigue. Above the cockpit you'll find the cabinets for the entertainment center. A 24" flatscreen TV is paired with numerous options, including a home theater system with surround sound speakers and a digital satellite system.

PANAVIEW™

1-PIECE WINDSHIELD

The Neptune's contemporary styling is accented by some remarkable features that make it also one of the safest coaches on the road. Our exclusive Panaview™ 1-piece windshield provides the largest unobstructed view in the industry. Slender side pillars increase your peripheral vision and the wipers are conveniently mounted below your field of view. The 17.5" power heated mirrors are also mounted on the front cap—so you don't have to turn your head away from the road to see.



Ebony Vine II | 34SBD ▲





A) The impressive dash features an eagle burlwood instrumentation panel and large, easy-to-read gauges. To the right of the steering wheel is the monitor for the rear vision system with audio and an adjustable camera. You also have the option of a 3-camera rear vision system, expanding your view of the sides and to the rear of the coach.

B) The Roadmaster chassis provides for large pass-through storage spaces which easily accommodate larger items such as sports equipment or patio furniture. Our side-hinged baggage doors are easier to open, giving you a better view and making it a snap to load and unload.

WE'VE GOT YOUR BACK.

- Live customer support 24/7/365
- 350 Nationwide Service Centers
- Free first-year enrollment in our Owner Advantage Roadside Assistance Program
- Call 1-800-634-0855 or 1-800-650-7337 to arrange a tour of one of our state-of-the-art production facilities in Indiana or Oregon.



WHERE ALL THE DETAILS COME TOGETHER.

Holiday Rambler has long set the standard with warm, inviting interiors that feature a perfect harmony of fabrics, accents and carpeting. We've also led the way with stunning woodwork and superb craftsmanship, including hardwood raised panel cabinet doors, self-supporting top-hinged overhead doors and heavy-duty ball bearing guides. Select the combination that suits you best to customize your Neptune and make it distinctively your own.

- A. BEDSPREAD
- B. SOFA
- C. CORIAN®
- D. ACCENT
- E. CARPET





EXTERIOR COLORS/WOODS/FABRICS

VINYL (STANDARD)



FULL-BODY PAINT (OPTIONAL)





MOROCCAN SUNSET

VINYL (STANDARD)



FULL-BODY PAINT (OPTIONAL)





SAVILLE ROW

VINYL (STANDARD)



FULL-BODY PAINT (OPTIONAL)





BRONZEVILLE



NEPTUNE HARDWARE

Our elegant cabinet hardware design features a satin brass finish.



BETTER
STAIN
PROTECTION

Manufactured in, not added on. For added protection against stains, soil repellent is applied to virtually all upholstery fabric during the finishing process for superior coverage.*

*Brand and application of upholstery fabric protection may vary depending on date recreational vehicle was manufactured.



NEW VINTAGE OAK



CHAMPAGNE SELECT



NEWPORT CHERRY



JADESTONE



VINYL (STANDARD)



FULL-BODY PAINT (OPTIONAL)



EBONY VINE II



VINYL (STANDARD)



FULL-BODY PAINT (OPTIONAL)

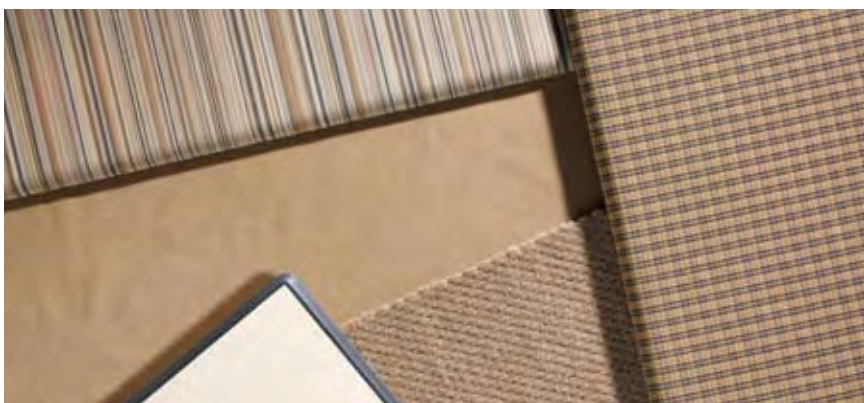

BLACKWOOD MANOR II — featuring fabrics by Liz Claiborne



VINYL (STANDARD)



FULL-BODY PAINT (OPTIONAL)

EXTERIOR COLORS/WOODS/FABRICS

ROADMASTER RAIL R4R CHASSIS

You can count on the Roadmaster Rail R4R chassis to give the 2006 Neptune the very best performance in its class. That's because the chassis is designed exclusively to the standards of a luxury motorcoach and is custom-built to the exact specifications of each floorplan. We invite you to take a few minutes and discover all the ways Roadmaster offers you the very best in safety, reliability, comfort and convenience.



The Neptune features Holiday Rambler's exclusive Alumaframe® Superstructure. Our revolutionary system of aluminum C-Channel crossmembers runs the entire length of the unit, with double-welded intersections for added strength. This rigid design is both lighter and sturdier than wood or tubular aluminum frames — and much more reliable than butt-welded or screwed joint designs. From dirt roads to potholes, you can count on Alumaframe® to handle the relentless stresses of the road and provide superior structural integrity for many years to come.

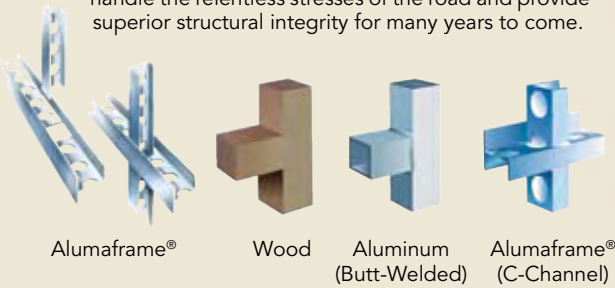

Alumaframe®

Wood

Aluminum (Butt-Welded)

Alumaframe® (C-Channel)

A steel cage cockpit gives the Roadmaster chassis incomparable strength and safety in the front of the coach.

Every Roadmaster chassis features a steel firewall for added protection in the cockpit.

The intercooler is stacked on top of the radiator, with an aluminum core, instead of steel components sandwiched together, for the best cooling package in the industry.



Cushion Air Glide Gold Suspension System with four air bags and four gas pressured shock absorbers for superb ride and handling.

CHASSIS AND CONSTRUCTION



SLIDE-OUT CONSTRUCTION:

When you get a Holiday Rambler, you can be sure the slide-out boxes are some of the strongest and most reliable you'll find anywhere. They feature our exclusive multi-layer construction to give you maximum insulation and to reduce the chance of warping, twisting or shifting.

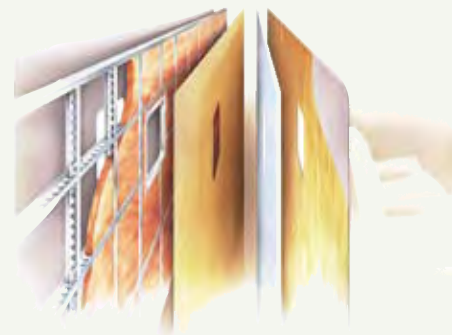

TRUSS SYSTEM WITH RUST INHIBITOR:

This steel truss system is engineered as part of the chassis and provides outstanding strength and rigidity, as well as the convenience of pass-through storage. To prevent corrosion, the structure is pre-primed and coated with rust-inhibiting paint.

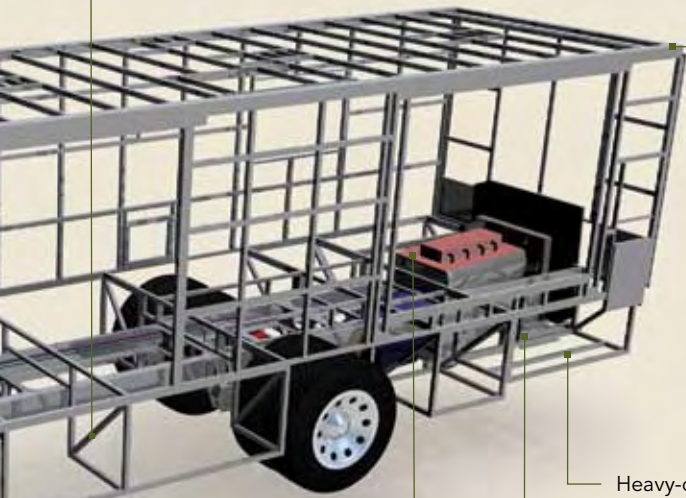

Heavy-duty steel undercarriage and firewall for unsurpassed safety, strength and durability.

An active suspension control system that automatically levels the coach for superior front-to-rear balance and reduced side-body sway.

Master the highways and byways with Neptune's rugged Cummins® ISB 300 HP engine with 600 ft./lbs. of torque and an Allison® 2500 MH 5-speed World Transmission. The new electronic shift pad offers added convenience.



9-LAYER ROOF: (top to bottom)

- One-piece peaked fiberglass roof
- Luaun backing
- Thick, tapered bead foam insulation
- Aluminum double I-beam superstructure filled with fiberglass insulation
- Vapor barrier
- Structure foam: thermal insulative barrier
- 1/2" bead foam insulation
- Foam padding for extra insulation
- Padded vinyl ceiling



AT HOLIDAYRAMBLER.COM, WE'RE ALWAYS OPEN.

Visit our website anytime day or night to check out the latest product news and updates. You can also take a factory tour, find a dealer near you, get information on club events and much more. It's also an easy way to contact us via e-mail.

www.holidayrambler.com

5-LAYER EXTERIOR WALL: (left to right)

- Smooth gel coat fiberglass is standard
- Interlocking C-Channel filled with 1-1/2" fiberglass insulation bonded in place so it doesn't sag or leave spaces uninsulated
- Vapor barrier
- Bead foam adds comfort, saves energy and provides a thermal insulative barrier
- Interior paneling



4-LAYER FLOOR: (top to bottom)

- Structurwood™
- Blue foam insulation
- 1-1/2" aluminum tube
- Three-ply poly underbelly

BODY CONSTRUCTION: FEATURES		OPTIONS
<ul style="list-style-type: none"> Alumaframe® Superstructure Steel Cage Cockpit Construction One-Piece Peaked Fiberglass Roof with Fiberglass Insulation Smooth Gel Coat Fiberglass Exterior Walls Front and Rear Molded Fiberglass Caps One-Piece Front Windshield Interior Height, 84" One-Piece Generator Access Door Rear Engine Doors with Struts Fiberglass Engine Cover Aluminum-Framed Floor on Steel Trusses Structurwood™ Flooring Electric Flush-Floor Stepwell Cover Interior Paneling with 3/4" Insulation 	<ul style="list-style-type: none"> Foam Insulated Floor Framing with 3-Ply Underbelly 17.5" Power Heated Remote Exterior Mirrors Low-Profile Sealed LED Marker Lights Integrated Metal Fuel Door with Lock 30" Deep Bedroom Slide-Out Houses Side-Hinged Baggage Doors; All Door Locations with Redesigned Extrusion and Latch Locations One-Piece Polyethylene Pass-Through Storage Compartment Painted Mask and Skirt with Vinyl Exterior Graphics Interior Entry Step Storage Roof Ladder Undercoating 	<ul style="list-style-type: none"> Deluxe Full-Body Paint with Vinyl Graphics 17.5" Chrome Power Heated Remote Mirrors 3M Film Front Mask Full-Length Mud Flap Standard Run Savings Package: Deluxe Full-Body Paint with Vinyl Graphics, 17.5" Chrome Power Heated Remote Mirrors, 3M Film Front Mask, Full-Length Mud Flap, 3-Camera Rear Vision System with Audio and Adjustable Center Camera, Roof-Mounted Air Horns, Large Four-Door Refrigerator with Ice Maker (N/A with Pantry), Washer/Dryer Prep, 20" Flatscreen Color TV with Remote Control in Bedroom, Porcelain Stool, Fantastic 12V Attic Fan with Rain Sensor with Electronic Wall Thermostat in Bath, Eclipse Automatic Textured Vinyl Patio Awning
CHASSIS/ENGINE/SUSPENSION: FEATURES		
<ul style="list-style-type: none"> Roadmaster R4R Rail Chassis Cummins® ISB 300 HP Engine with Allison® 2,500 MH 5-Speed World Transmission Push-Button Shift Pad on 2,500 MH Transmission Engine Displacement: 5.9L/359 Cu. In. Torque: 600 lbs./ft. Max. Net at 1,600 RPM Chrome Exhaust Tip — Engine 	<ul style="list-style-type: none"> 75-Gallon Fuel Tank Dual Fuel Fill 160 Amp Alternator Rear Axle Ratio: 4.78:1 Radial Tires: 255/70R/22.5 Stainless Steel Wheel Simulators Four Gas Shock Absorbers Four Air Bags 	<ul style="list-style-type: none"> Anti-Lock Braking System with Full Air Brake Pre-Wire for Supplemental Braking System Air Cleaner Restriction Indicator Fuel/Water Separator Remote Transmission Fill Fully Automatic Hydraulic Leveling System 7,000 Lb. Hitch Receiver with Dual Connector (4-Pin or 7-Pin)
COCKPIT: FEATURES		OPTIONS
<ul style="list-style-type: none"> Fiberglass Automotive Dash with Eagle Burlwood Instrumentation Panel CD Player/Radio with Six Speakers Power Sunvisors Pilot and Co-Pilot Side Window Pull-Down Sunshades Front Wood-Framed Cabinet Door with Smoked Glass over Front Entertainment Center Systems (Pilot Side); Front Overhead Raised Panel Cabinet Door (Co-Pilot Side) Front Cab over Televisions Secured with Steel Framing Rear Vision System with Audio and Adjustable Camera Intermittent Windshield Wipers 6-Quart Tank for Windshield Fluid 	<ul style="list-style-type: none"> Tilt/Telescopic Steering Wheel Cruise Control Power Steering ICC Light Switch on Driver's Side Console Electric Automotive Horn Wired to Center Hub of Steering Wheel Molded Co-Pilot Side Console with Two-Tier Cup Holder Map Pocket on Pilot Side Console Fold-Down Drink Holder on Pilot Seat Side Console New Style Soft Touch Vinyl Pilot and Co-Pilot Seats Six-Way Power Pilot Seat Seat Belt Warning Light on Dash 	<ul style="list-style-type: none"> Auxiliary Defroster 3-Camera Rear Vision System with Audio and Adjustable Center Camera Roof-Mounted Air Horns
APPLIANCES AND ACCESSORIES: FEATURES		OPTIONS
<ul style="list-style-type: none"> Large Double-Door Refrigerator with Ice Maker 8 Cu. Ft. High-Output Three-Burner Cooktop Removable Solid Surface Range Covers Spacesaver Convection Microwave 24" Flatscreen Stereo Color TV with Remote Control in Living Area TV Antenna Pre-Wire for Bedroom TV DVD Prep and Video Control Box with Booster and RF Modulator Exterior Hook-Ups for DSS Dish and Cable 	<ul style="list-style-type: none"> Digital Satellite System Prep Interior Cable TV Hook-Up and Telephone Jacks DVD Player Options Wired to Both TV Locations Exterior Gas Line Hook-Up Prep for LP Accessories 	<ul style="list-style-type: none"> Large Double-Door Refrigerator with Ice Maker 10 Cu. Ft. (N/A: 36SBT) Large Four-Door Refrigerator with Ice Maker (N/A with Pantry) High-Output Three-Burner Range with Oven Stainless Steel Spacesaver Microwave and Refrigerator, Any Combination (N/A with Hardwood Raised Panel Doors on Refrigerator) Washer/Dryer Prep Combination Washer/Dryer 20" Flatscreen Color TV with Remote Control in Bedroom DVD Player (N/A with Home Theater Option) Home Theater System with DVD/VCR Player with Surround Sound Speakers Fully Automatic Digital Satellite System Exterior Entertainment Center, CD Player Radio with Two Speakers

INTERIOR: FEATURES

- New Vintage Oak Cabinetry
- Raised Panel Hardwood Cabinet Doors
- Cabinet End Panels
- Hardwood Raised Panel Doors on Refrigerator
- Wallpaper Border inside Private Bath
- Self-Supporting Top-Hinged Overhead Storage Doors, except Side Wing Cabinets; Doors inside Cockpit will have Mini-Struts and Positive Catches on All Other Doors
- Heavy-Duty Ball-Bearing Drawer Guides
- Wood Cabinet Drawer Boxes
- Metal Interior Grab Handle on Dash Accessories
- Integrated Cup Holder in Slide-Out next to Sofa
- Solid Surface Kitchen Countertop with Under-Mounted Stainless Steel Sink with Two Sink Covers
- Toe Kicks, Kitchen and Bath Base Cabinets
- Kitchen Countertop End Splash (36PDQ)
- Solid Surface Bath Lavatory Countertop with Integrated Bowl
- All Other Countertops Laminated with Wood Edge, except Kitchen and Bath Lavatory
- Kitchen Overhead Cabinets with Adjustable Shelf
- Kitchen Pantry next to Refrigerator with Adjustable Shelves in Upper Cabinet and Three Drawers Below (N/A with Four-Door Refrigerator Option)
- Second Kitchen Pantry next to Refrigerator with Adjustable Shelves in Upper Cabinet and Three Drawers Below (36SBT, 37PBD)
- Removable Silverware Tray, Kitchen Base Cabinets (N/A with Range Option) (34PDD, 36PDQ)
- Trash Can in Kitchen Base Cabinet
- Sink Cover Storage Area inside Kitchen Base Cabinet under Cooktop (N/A with Range Option) (34PDD, 36PDQ)
- Sink Cover Storage Area inside Kitchen Base below Kitchen Sink Area (36PDD, 36SBT)
- Mirrors behind Stove Area in Kitchen
- Laminated Tile Flooring in Kitchen, Bath and Entryway
- Upgrade Nylon Carpeting with Pad in Living Area and Bedroom
- Engine Rug Cover (34PDD, 36PDD, 36PDQ)
- Soft Touch Padded Vinyl Ceiling
- Wood Slide-Out Fascia with Vinyl Inserts
- Elongated Octagon Beveled Edge Mirror, Wainscoting Accent under Mirror (N/A: 37PBD)
- Bath Door with Accent Trim on Hallway Side
- Wood Trim for Bath Door Opening Hallway Side
- French Style Door into Bedroom (36PDQ)
- Wood Louvers on Washer and Dryer Doors
- Crown Molding in Bedroom and Living Area on All Open Walls
- Medicine Cabinet

- Bathroom Lavatory Mirror
- Oversized Rear Wardrobe Closet with Deluxe Brass Mirror Door Frames (34PDD, 36PDD, 36PDQ)
- Bedroom Swing-Away TV Cabinets with Bedroom TV Option (N/A: 36PDQ)
- Queen Bed with Shirt Closets and Nightstands
- Bedroom Dresser Foot of Bed with Drawers (N/A: 36SBT, 37PBD)
- Curbside Bedroom Slide-Out Wardrobe with TV Cabinet (36SBT)
- Bedspread with Reverse Sham for Pillows
- Wood Perimeter Framed Headboard with Padded Fabric Insert
- Pleated Day/Night Blackout Shades in Living Area and Bedroom
- Mini Blinds in Kitchen and Bathroom
- Soil Repellant on Fabric

OPTIONS

- Decors: Moroccan Sunset, Saville Row, Bronzeville, Jadestone, Ebony Vine II, Liz Claiborne — Blackwood Manor
- Wood Choices: Newport Cherry, Champagne Select

FURNITURE: FEATURES

- Queen Bed with Shirt Closets and Nightstands
- Party Table behind Co-Pilot Seat (N/A: 36PDQ, 36SBT)
- Arched Back Wood Booth Dinette with Side-Sliding Table Top and 30" Drawer
- Forward-Facing Seat Belts in Booth Dinette inside Living Area Slide-Out
- Roadside Furniture: New Style Fabric Jackknife Sofa (N/A: 36PDQ)
- Roadside Furniture: New Style Fabric Swivel Glider Barrel Chair (36PDQ)
- Curbside Furniture: New Style Fabric Jackknife Sofa (36PDQ, 36SBT)
- Curbside Furniture: New Style Fabric Swivel Glider Barrel Chair (N/A: 36PDQ, 36SBT)

OPTIONS

- Roadside Furniture: New Style Soft Touch Vinyl Swivel Recliner in Place of Fabric Swivel Glider Barrel Chair (36PDQ)
- Roadside Furniture: OptimaLeather™ Euro-Recliner with Heat, Massage and Ottoman in Place of Fabric Swivel Glider Barrel Chair (36PDQ)
- Roadside Furniture: New Style Fabric Hide-A-Bed Sofa with Air Mattress and Two Pillows (N/A: 36PDQ)
- Curbside Furniture: New Style Soft Touch Vinyl Swivel Recliner in Place of Fabric Swivel Glider Barrel Chair (N/A: 36PDQ, 36SBT)
- Curbside Furniture: OptimaLeather™ Euro-Recliner with Heat, Massage and Ottoman in Place of Fabric Swivel Glider Barrel Chair (N/A: 36PDQ, 36SBT)

- Curbside Furniture: New Style Fabric Jackknife Sofa in Place of Swivel Glider Barrel Chair (37PBD)
- Curbside Furniture: New Style Soft Touch Vinyl Jackknife Sofa in Place of Fabric Jackknife Sofa (36PDQ, 36SBT)
- Curbside Furniture: New Style Fabric Hide-A-Bed Sofa with Air Mattress and Two Pillows (36PDQ)
- Freestanding Dinette with Wall Cabinet, Two Freestanding Chairs and Two Folding Chairs

ELECTRICAL SYSTEMS AND LIGHTS: FEATURES

- 50 Amp 120V Distribution Panel and Power Cord
- Energy Management System
- 60 Amp Electronic 12V Power Converter
- Onan® 5.5 kW Diesel Generator
- Two 6V House Batteries
- Battery Disconnect Switch at Front Door
- 12V and 110V Outlet in Cockpit Area, 110V Outlet
- Porch Light and Exterior Step Light on Same Switch
- Exterior Power Double Entry Step, with Light
- Interior Stepwell Entry Step Lights
- Water Pump Switch in Service Bay Area and Convenience Center
- Lights in Outside Storage Compartments
- 110V Receptacles in Outside Storage Compartment
- Underhood Utility Light
- Reception and Phone Jack in Dinette Area
- Directional Map Lights Pilot and Co-Pilot Seats
- Redesigned Convenience Center in Hallway
- Storage Compartment Tank Monitor Gauge
- Fluorescent Lights under Kitchen Overhead with Night Light
- Fluorescent Ceiling Lights Throughout
- Fluorescent Ceiling Lights inside Living Area Slide-Out House
- Decorative Wood Framed Galley Ceiling Fluorescent Light

- Decorative Lighting Brass Living Room Wall Light, Dinette Overhead and Cosmetic Vanity Light
- Halogen Lights under Living Room, Dining Room and Bedroom Dresser Overhead Cabinets
- Bullet Lights over Bed Brass Finish with His and Hers Switches

OPTIONS

- 2,000 Watt Inverter with Two Additional Batteries (4 Total, 6 Volt Batteries)
- Manual Retracting Power Cord Reel (N/A: 36SBT)
- Onan® 8.0 kW Quiet Diesel Generator

PLUMBING AND LP SYSTEMS: FEATURES	OPTIONS	
<ul style="list-style-type: none"> Kitchen Under-Mounted Stainless Steel Sink with Single Lever Satin Nickel Faucet with Pullout Sprayer Separate Satin Nickel Finish Faucet for Filtered Water Bath Lavatory Faucet Single Handle Brass Finish Demand Water System and Water Pump 10-Gallon LP Gas/Electric Water Heater with Electronic Ignition, DSI Winterization Valving System Water Heater Bypass Valving 	<ul style="list-style-type: none"> Toilet with Sprayer No-Fuss Flush Holding Tank Rinsing System Insulated Systems Compartment with Easy Access to Hook-Up New Style Shower inside Wet Bay with Hot/Cold Water Soap Dispenser inside Utility Bay Pressurized Water Fill Contained Storage Area for Sewer Hose One-Piece Fiberglass Shower Brass Shower Door Frame with Obscure Glass 	<ul style="list-style-type: none"> RV Sani-Con 2 System Holding Tank Draining System Bathtub Porcelain Stool
HEATING, VENTS AND AIR CONDITIONING: FEATURES	OPTIONS	
<ul style="list-style-type: none"> One 13.5M BTU and One 11.0M BTU Roof Air Conditioner with Ducted Air and Analog Thermostat Control, New Standard 34' Coach Electronic Ignition Furnace: (One 35M BTU 34PDD) (Two 25M BTU 36PDD) (One 40M BTU 36PDD, 36SBT, 37PBD) Electronic AC/Heat Climate Control System In-Floor Ducted Heating System Kitchen Powered Attic Fan with Wall Control of Automatic Dome and Fan Power 	<ul style="list-style-type: none"> Bath Powered Attic Fan with Wall Control of Automatic Dome and Fan Power 12V Heater in Wet Bay, Heat Pad on Fresh Tank Antique Finish Metal Air Return Grill for Furnace (All Except 36PDD are Wood) Metal Floor Registers Antique Brass 	<ul style="list-style-type: none"> Dual 13.5M BTU Air Conditioner with Ducted Air and Analog Thermostat Control in Place of One 13.5M BTU and One 11.0M BTU Roof Air Conditioner Dual 13.5M BTU Air Conditioner with Heat Pumps and Digital Thermostat Control in Place of One 13.5M BTU and One 11.0M BTU Roof Air Conditioner Fantastic 12V Attic Fan with Rain Sensor with Electronic Wall Thermostat in Kitchen Fantastic 12V Attic Fan with Rain Sensor with Electronic Wall Thermostat in Bath
WINDOWS, DOORS AND AWNINGS: FEATURES	OPTIONS	
<ul style="list-style-type: none"> Dual Pane Sliding Flush-Mount Windows Front Entry Door with Clear Glass, Removable Screen and Anti-Skid Steps Exterior Entry Door Grab Handle Two Interior Grab Handles and One Exterior Grab Handle 	<ul style="list-style-type: none"> Textured Vinyl Patio Awning Textured Vinyl Front Door Awning Topper Slide-Out Awnings Living Area and Bedroom Tinted Skylight in Bathroom with Protecta Glaze 	<ul style="list-style-type: none"> Eclipse Automatic Textured Vinyl Patio Awning Textured Vinyl Side Bedroom Window Awnings (N/A: 36PDD, 36SBT) Textured Vinyl Window Awnings Living Area Slide-Out House Windows Textured Vinyl Window Awnings Bedroom Slide-Out House Windows (36PDD, 36SBT, 37PBD)
SAFETY: FEATURES		
<ul style="list-style-type: none"> Fire Extinguisher Deadbolt Lock on Entrance Door 120V GFI Protected Circuit Kitchen, Bath and Exterior 	<ul style="list-style-type: none"> LP Gas Detector Smoke Detector Carbon Monoxide Detector 	<ul style="list-style-type: none"> Driver and Passenger Three-Point Seat Belts Third Brake Safety Light Egress Window

Weights	34PDD	36PDD	36PDDQ	36SBT	37PBD
Gross Vehicle Weight Rating (Lbs.)	26,500	26,500	26,500	26,500	26,500
Gross Combined Weight Rating (Lbs.)*	33,000	33,000	33,000	33,000	33,000
Gross Axle Weight Rating (Front) (Lbs.)	9,500	9,500	9,500	9,500	9,500
Gross Axle Weight Rating (Rear) (Lbs.)	17,000	17,000	17,000	17,000	17,000
Measurements					
Wheelbase	204"	228"	228"	228"	240"
Overall Length	35' 1"	36' 11"	36' 11"	36' 11"	37' 11"
Overall Height with A/C	12' 5"	12' 5"	12' 5"	12' 5"	12' 5"
Interior Height	7' 0"	7' 0"	7' 0"	7' 0"	7' 0"
Interior Width	94.5"	94.5"	94.5"	94.5"	94.5"
Exterior Width	100.5"	100.5"	100.5"	100.5"	100.5"
Tank Capacity**					
Water Heater (Gal.)	10	10	10	10	10
Gray Tank (Gal.)	52	52	52	52	52
Black Tank (Gal.)	52	52	52	52	52
Fresh Tank (Gal.)	92	92	92	92	92
Fuel Tank (Gal.)	75	75	75	75	75
LP Tank (Gal.)***	38	38	38	38	38

* Towing capacity is limited by GCWR; your vehicle's towing capacity is the difference between the GCWR and the actual vehicle weight, including all water, fuel, passengers and cargo. Your towed vehicle should be equipped with auxiliary brakes if the weight of the towed vehicle exceeds 1,000 lbs. Consult your owner's manual for further towing information.
 ** Variances in the fabrication and installation of the tanks may cause the actual "usable capacity" to be greater or less than the capacities designated above.
 *** Actual filled LP capacity is 80% of listing due to safety shut-off required on tank.

Due to the large variety of options and floorplan arrangements available to our customers, actual weights for each unit can differ significantly. Holiday Rambler provides a weight sticker on each unit we produce which includes that unit's tank capacities and approximate weight. Consult your local Holiday Rambler dealer for unit availability and further information.

The information printed in this brochure reflects product design, fabrication, and component parts at the date of printing. The manufacturer reserves the right, at any time, to make changes in product design or material or component specifications as its sole option, without notice. This includes the substitution of components of a different brand or trade name, which will result in comparable performance. All information printed in this brochure is subject to change after the date of printing. Some features shown or mentioned in this brochure are optional and may only be available in selected floorplans. Photographs may show props or decorations that are not standard equipment on Holiday Rambler models. Holiday Rambler, the HR logo and its design, are registered trademarks. All other products and company names are trademarks and/or registered trademarks of their respective holders.

While the color of the motorhome's exterior and the interior fabrics depicted in this sales brochure are fair and reasonable depictions, the colors depicted may not be an exact match of the actual colors because of the variances in photo-processing and variances caused by inserting the photographs within the sales brochure. Due to product improvements, changes during the model year and/or transcription errors that may occur, information represented within this brochure may not be accurate at the time of your purchase. If certain information is significant to your purchasing decision, please confirm the information with your dealer prior to submitting your order.

The actual overall length of the recreational vehicle may differ from that indicated in the brochure due to variances in the manufacturing process and/or installed components. The actual length may be greater or less than that indicated.

Component part and appliance manufacturers issue limited warranties covering those portions of the recreational vehicle not covered by the Limited Warranties issued by Monaco Coach Corporation. To learn which specific component parts and appliances are excluded from the Limited Warranties issued by Monaco Coach Corporation, please contact your selling dealership or Monaco Coach Corporation directly, or review the warranty packet inside the recreational vehicle.

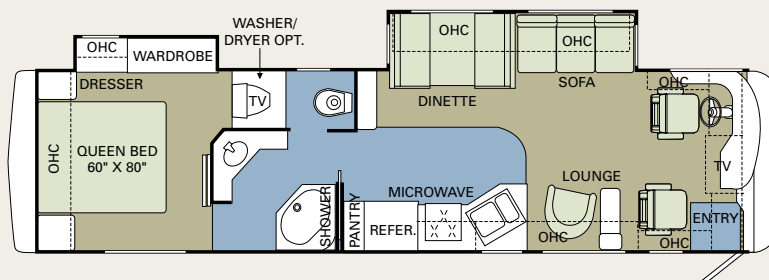
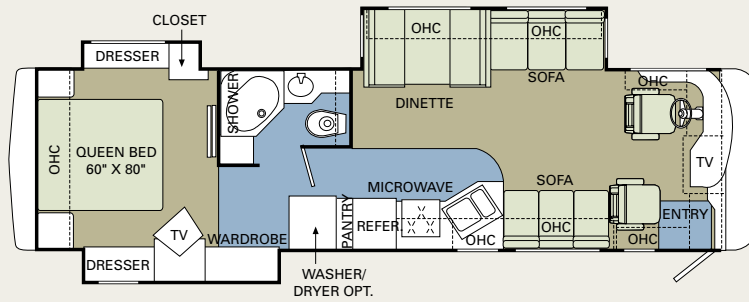
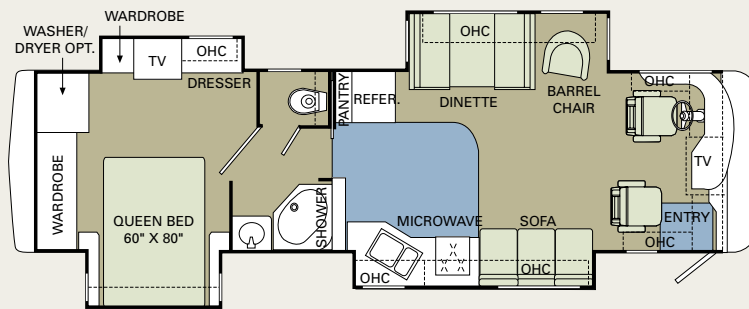
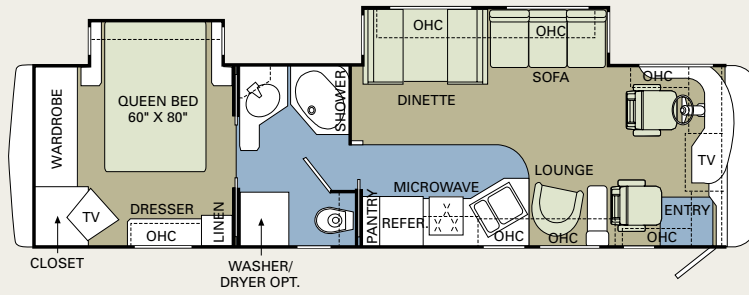
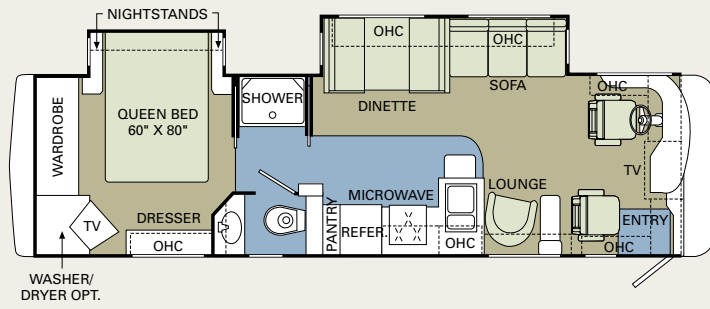

CARPET TILE

20 NEPTUNE® 06



Thank you for taking a closer look at the 2006 Neptune. In addition to its state-of-the-art technologies and creature comforts, this value-packed diesel coach includes countless conveniences and safety innovations you'll want to experience firsthand. Poke around. Kick the tires. Open and shut every door and drawer — twice. And most importantly, take a drive. You can count on our expert sales team to answer all your questions and demonstrate why this truly is the best experience the road has to offer.

WARRANTIES

12 MONTH/24,000 MILE basic limited warranty

5 YEAR/50,000 MILE limited warranty on aluminum or steel frame structure of sidewall, roof, front and rear cap

3 YEAR/36,000 MILE limited warranty on Roadmaster chassis

Applies to certain models. See owner's manual for complete details.

ALL EYES ON THE ROAD AHEAD.

If you're considering a Holiday Rambler, chances are you share our pioneer spirit. For us, it goes back to 1953, the year we introduced our first travel trailer. Since then, our countless innovations have helped create a rich, rewarding lifestyle — and a new way for families like yours to go exploring.

Yes, we're proud of our heritage — but we're not looking back. In these pages, you'll discover that we continue to lead the entire industry. With exciting new features, powerful chassis, remarkable floorplans and, as always, more ways of keeping you and your loved ones safe.

Whether you're looking for the value of a towable, the convenience and economy of a gas motorhome or the top-of-the-line luxury of a diesel coach — Holiday Rambler has an unbeatable model for your budget. Because in 2006, one thing's for sure. We're still paving the way.



HOLIDAY RAMBLER®

This is Living®

606 Nelson's Parkway Wakarusa, IN 46573

www.holidayrambler.com
(800) 245-4778

MONACO COACH CORPORATION

Monaco is traded on the New York Stock Exchange under the listing MNC.
© 2005, Monaco Coach Corporation 11/05 NPN: BROHNEP Litho in USA.

